

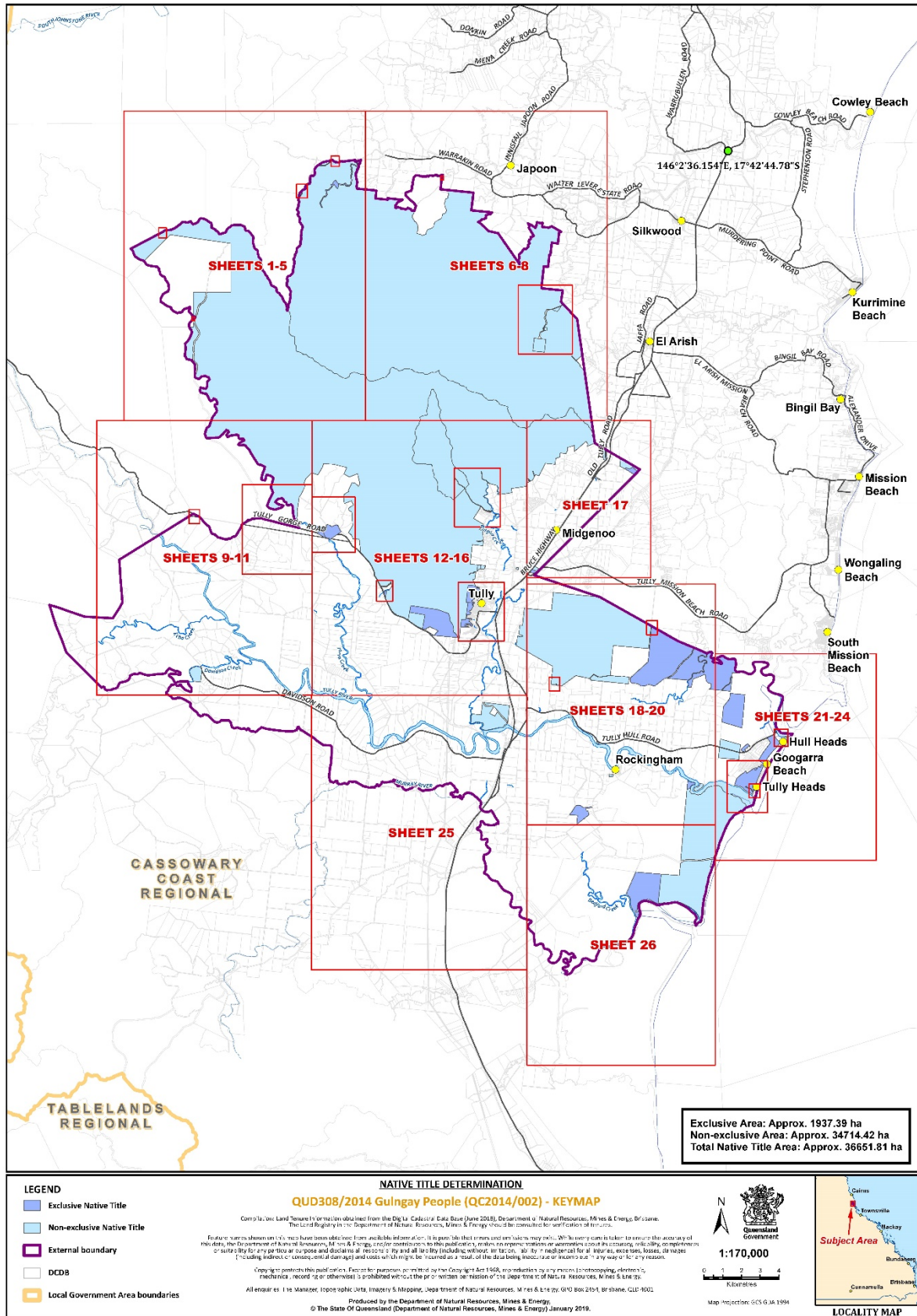

Schedule 6 – Map of Determination Area

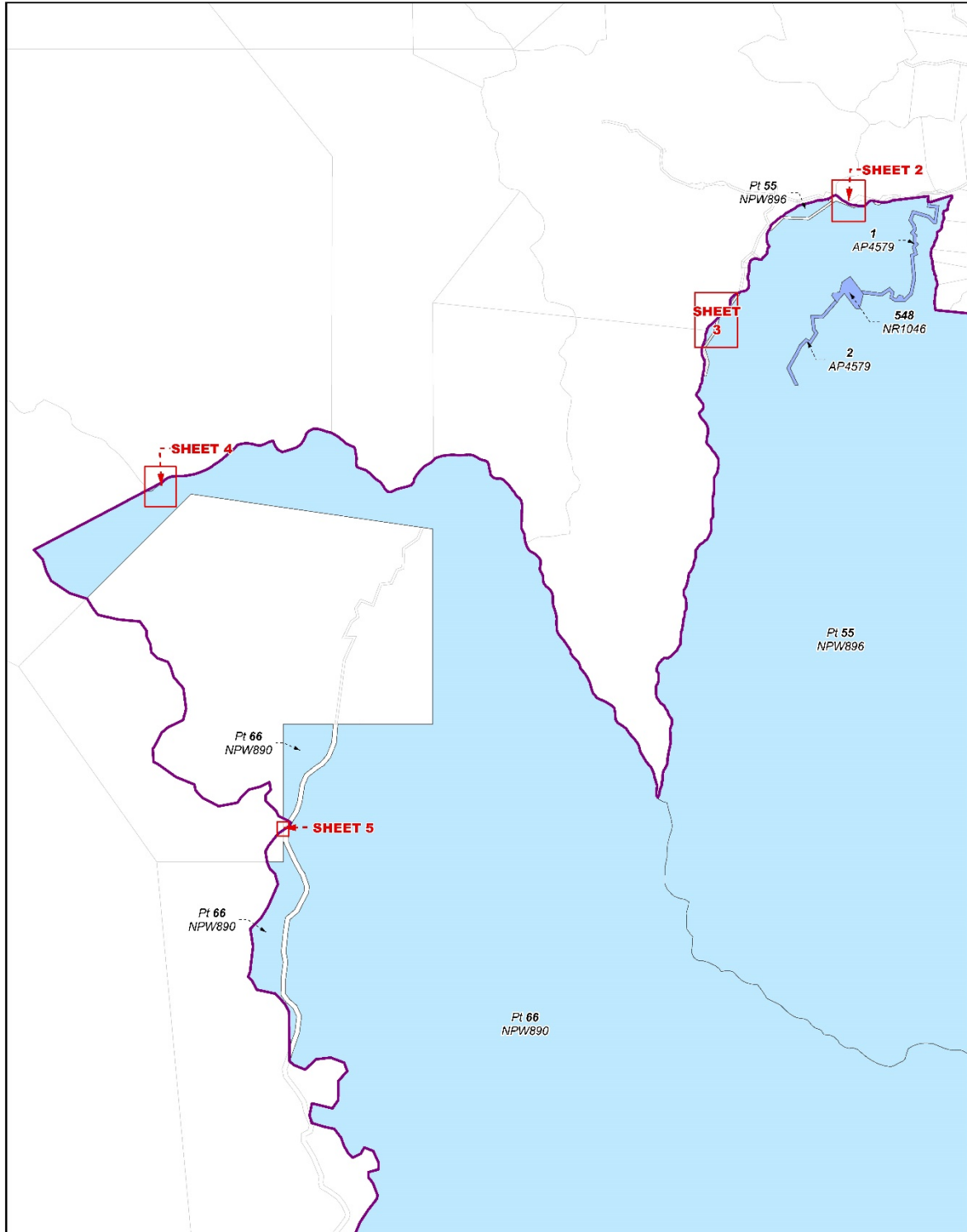

Document Path: K:\CLAIMMAP\2014\QCD2014_002 Gulngay People\Determinaion_Map\MXD\QC14_02_Gulngay_People_A3P_Determinaion_Keymap_20181129.mxd

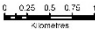
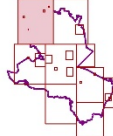

Document Path: K:\CLAIMMAP\2014\QCD2014_002 Gulngay People\Determinat...Map\MXD\QCD14_02_Gulngay_People_A3P_Determination_Mapbook_20181129.mxd

<p>LEGEND</p> <ul style="list-style-type: none"> Exclusive Native Title Non-exclusive Native Title External boundary DCDB 	<p>NATIVE TITLE DETERMINATION</p> <p>QUD308/2014 Gulngay People (QC2014/002) Sheet 1 of 26</p> <p><small>Copyright: Land Tenure Information obtained from the Digital Cadastre Data Base (June 2018), Department of Natural Resources, Mines & Energy, Brisbane. This (and any other) information is the property of Natural Resources, Mines & Energy should be consulted for verification of tenures.</small></p> <p><small>From the names shown on this map have been obtained from available information. It is possible that errors and omissions may exist. While every care is taken to ensure the accuracy of this data, the Department of Natural Resources, Mines & Energy, and its contractors, make no representation or warranty as to the accuracy, reliability, completeness or suitability of any data for any purpose and of course a responsibility and all liability (including without limitation, liability in negligence) for any injuries, expenses, costs, damages (including indirect or consequential) and costs which might be incurred in reliance on the data being inaccurate or incomplete, in any way or for any reason.</small></p> <p><small>Copyright remains the sole property of the person(s) named in the Copyright Act 1968, reproduction by any means (photographic, electronic, mechanical, recording or otherwise) is prohibited without the prior written permission of the Department of Natural Resources, Mines & Energy.</small></p> <p><small>All enquiries: The M&E Paper, Topographic Data, Imagery & Mapping, Department of Natural Resources, Mines & Energy, GPO Box 2451, Brisbane, QLD 4001.</small></p> <p><small>Produced by the Department of Natural Resources, Mines & Energy.</small></p> <p><small>© The State of Queensland (Department of Natural Resources, Mines & Energy) January 2019.</small></p>	 <p>1:45,000</p>  <p>Map Projection: GDA 1984</p>	 <p>SHEET KEY</p>
-------------------------------------------------------------------------------------------------------------------------------------------------------------------------------------------------------------------------------------------------------------------------------------------------------------------------------------------------------------------------------------------------------------------------------------------------------------------------------------------------------------------------------------------------------------------------------------------------------------------------------------------------------------------------------------------------------------------	---------------------------------------------------------------------------------------------------------------------------------------------------------------------------------------------------------------------------------------------------------------------------------------------------------------------------------------------------------------------------------------------------------------------------------------------------------------------------------------------------------------------------------------------------------------------------------------------------------------------------------------------------------------------------------------------------------------------------------------------------------------------------------------------------------------------------------------------------------------------------------------------------------------------------------------------------------------------------------------------------------------------------------------------------------------------------------------------------------------------------------------------------------------------------------------------------------------------------------------------------------------------------------------------------------------------------------------------------------------------------------------------------------------------------------------------------------------------------------------------------------------------------------------------------------------------------------------------------------------------------------------------------------------------------------------------------------------------------------------------------------------------------------------------------------------------------------------------------------------------------------------------------------------------------	------------------------------------------------------------------------------------------------------------------------------------------------------------------------------------------------------------------------------------	---------------------------------------------------------------------------------------------------------------

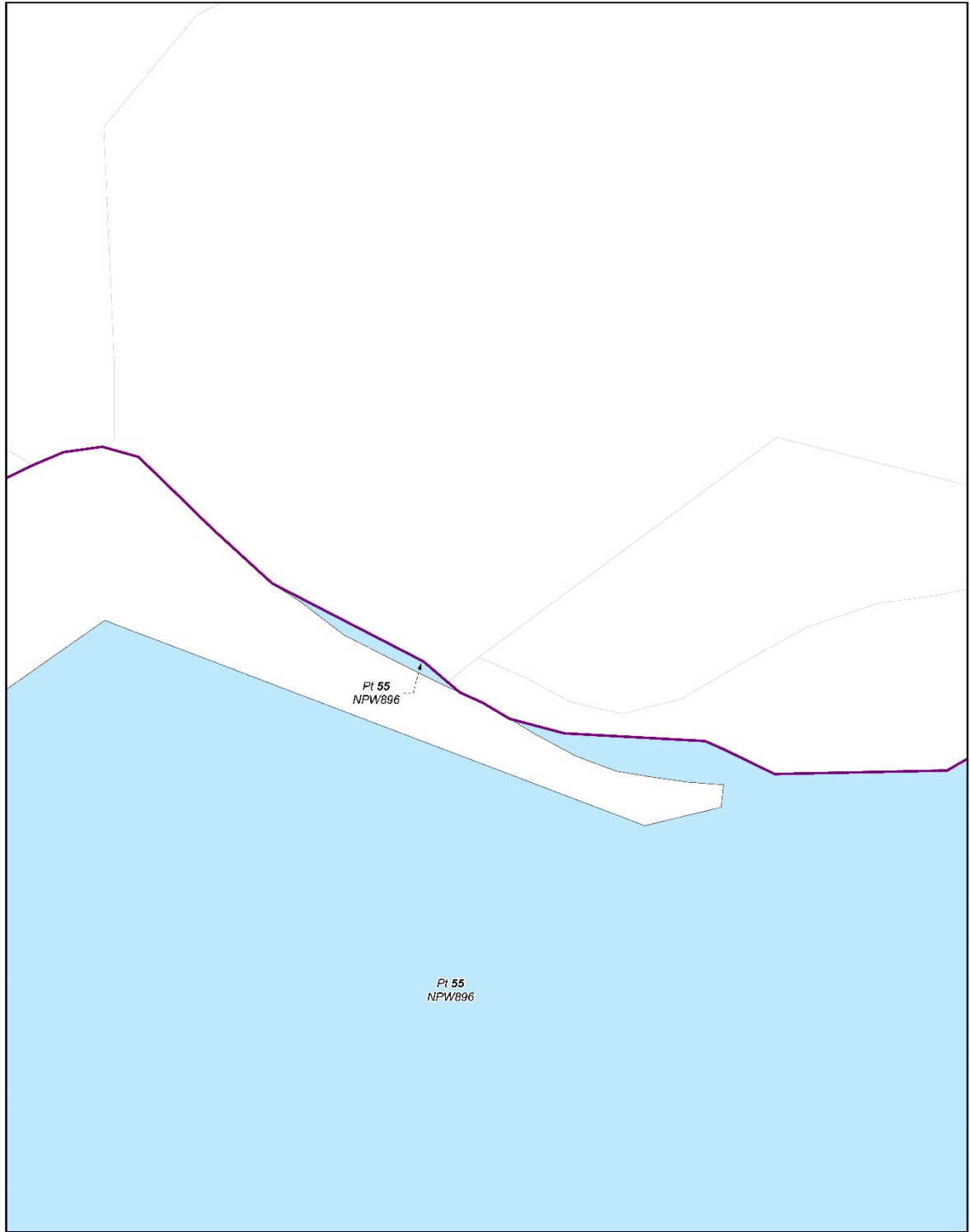

Document Path: K:\CLAIMMAP\2014\QCD2014_002_Gulngay_People\People_A3P_Determination_Map\MXD\QCD14_02_Gulngay_People_A3P_Determination_Mapbook_20181129.mxd

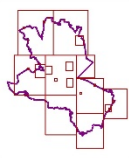
NATIVE TITLE DETERMINATION		
QUD308/2014 Gulngay People (QC2014/002) Sheet 2 of 26		
<p><small>Copyright: Land Tenure Information obtained from the Digital Cadastre Data Base (June 2018), Department of Natural Resources, Mines & Energy, Brisbane. Title (and integrity) in the Department of Natural Resources, Mines & Energy should be consulted for verification of tenures.</small></p> <p><small>Footprint names shown on this map have been obtained from available information. It is possible that errors and omissions may exist. While every care is taken to ensure the accuracy of this data, the Department of Natural Resources, Mines & Energy, and/or those subject to this data, do not make any representation or warranty as to the accuracy, reliability, completeness or suitability for any purpose and of social responsibility of any liability (including without limitation, liability in negligence) for any loss, expenses, costs, damages (including indirect or consequential) and costs which might be incurred in reliance on the data being inaccurate or incomplete, in any way or for any reason.</small></p> <p><small>Copyright permits this publication, save that for purposes permitted by the Copyright Act 1968, reproduction by any means (photocopying, electronic, mechanical, recording or otherwise) is prohibited without the prior written permission of the Department of Natural Resources, Mines & Energy.</small></p> <p><small>All enquiries: The Maps and Topographic Data, Imagery & Mapping, Department of Natural Resources, Mines & Energy, GPO Box 2451, Brisbane, QLD 4001.</small></p> <p style="text-align: center;"><small>Produced by the Department of Natural Resources, Mines & Energy, © The State Of Queensland (Department of Natural Resources, Mines & Energy) January 2019.</small></p>		
<p>LEGEND</p> <ul style="list-style-type: none"> Exclusive Native Title Non-exclusive Native Title External boundary DCDB 	 <p>1:1,500</p> <p><small>0 0.002500 0.005000 0.007500 0.010000 0.012500 0.015000</small> Kilometres</p> <p><small>Map Projection: GDA 1984</small></p>	 <p>SHEET KEY</p>

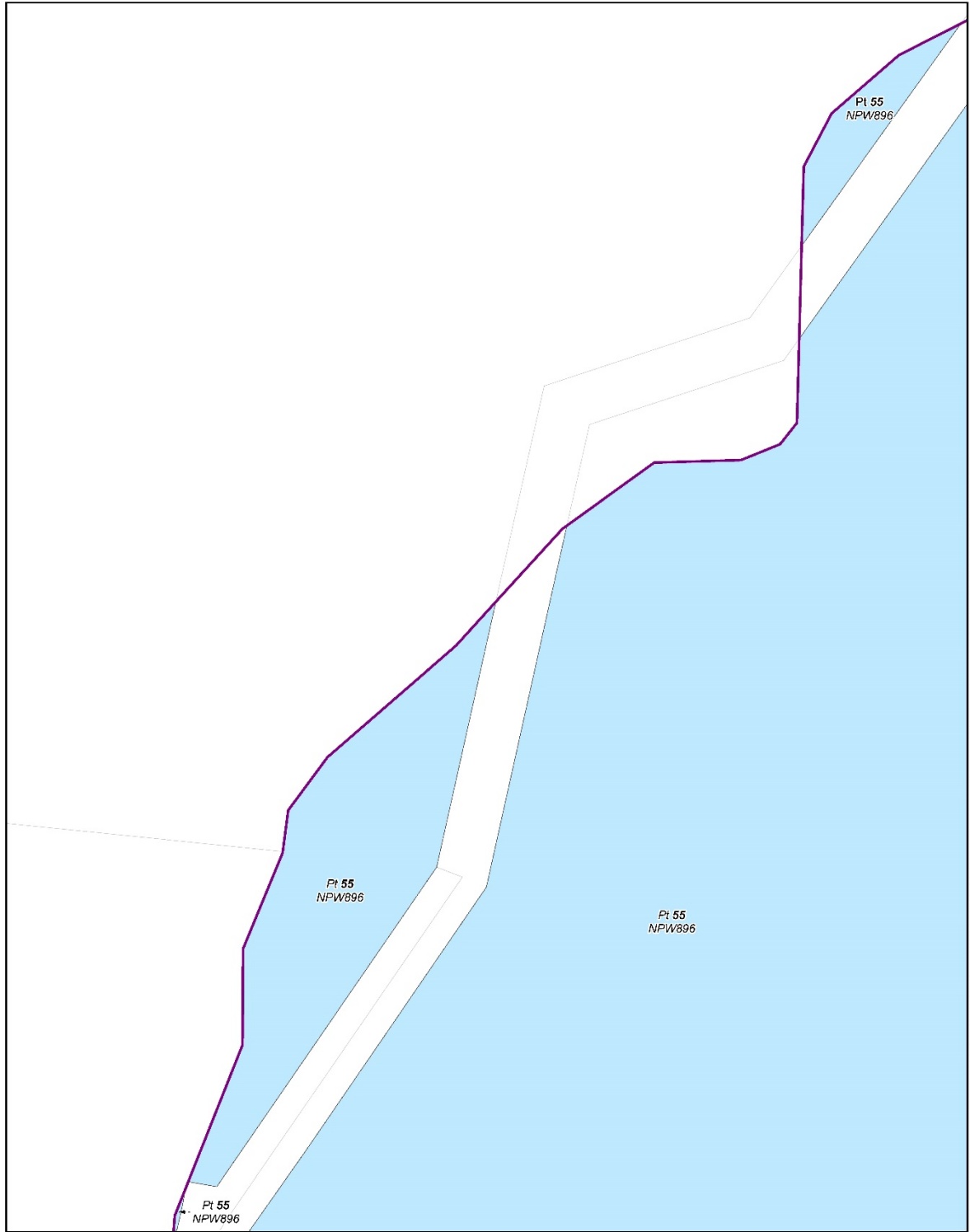

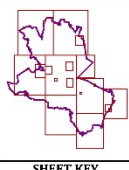

Document Path: K:\CLAIMMAP\2014\QCD2014_002_Gulngay_People\Determination_Map\MXD\QCD14_02_Gulngay_People_A3P_Determination_Mapbook_20181129.mxd

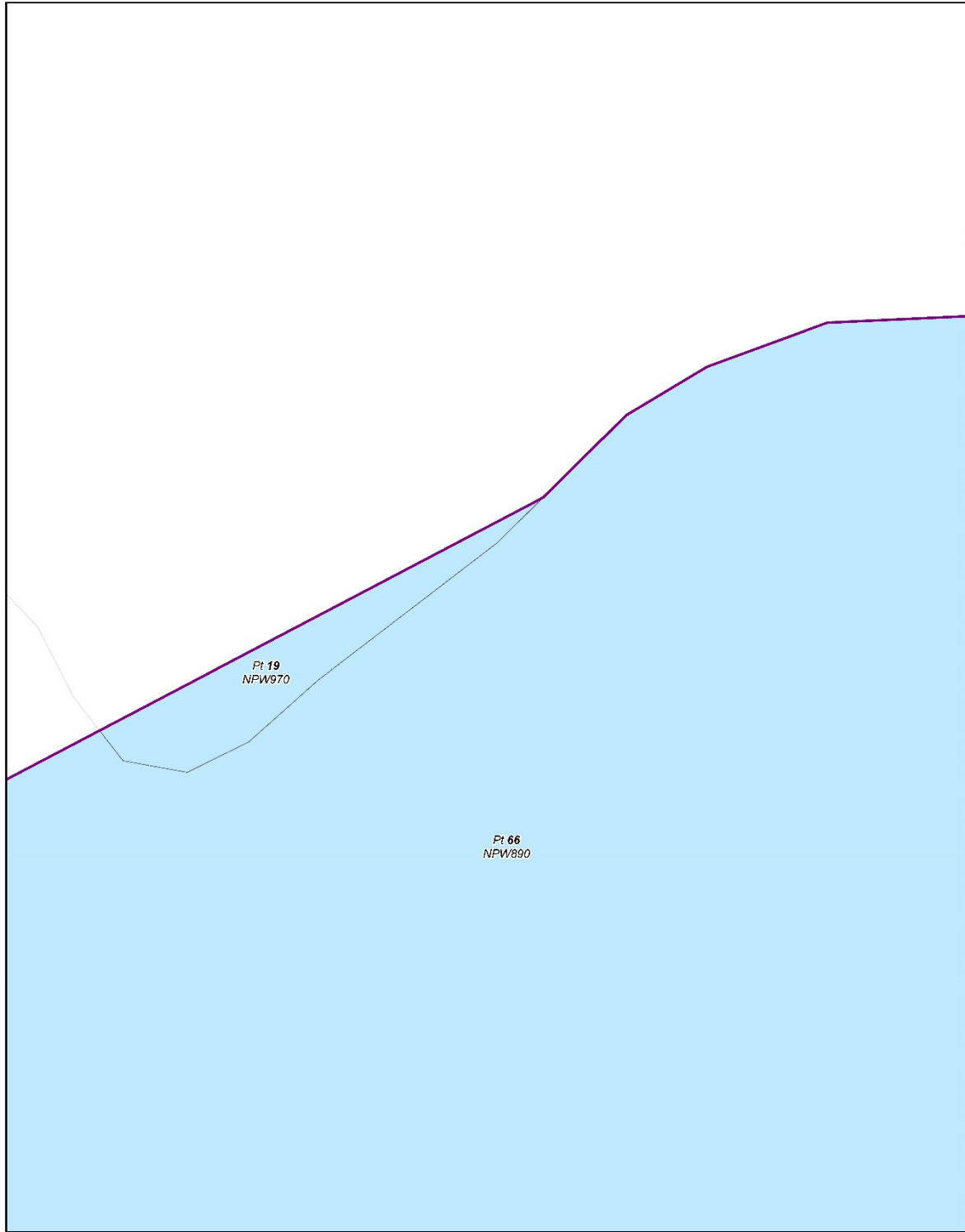
<p>LEGEND</p> <ul style="list-style-type: none"> Exclusive Native Title Non-exclusive Native Title External boundary DCDB 	<p>NATIVE TITLE DETERMINATION</p> <p>QUD308/2014 Gulngay People (QC2014/002) Sheet 3 of 26</p> <p><small>Copyright: Land Tenure Information obtained from the Digital Cadastre Data Base (June 2018), Department of Natural Resources, Mines & Energy, Brisbane. This (and any other) information is the Department of Natural Resources, Mines & Energy should be consulted for verification of tenures.</small></p> <p><small>Frontier names shown on this map have been obtained from available information. It is possible that errors and omissions may exist. While every care is taken to ensure the accuracy of this data, the Department of Natural Resources, Mines & Energy, and its contractors, make no representation or warranty as to the accuracy, reliability, completeness or suitability of any data for any purpose and of social responsibility and all liability (including without limitation, liability in negligence) for any injuries, expenses, costs, damages (including indirect or consequential) and costs which might be incurred in connection with the data being inaccurate or incomplete, is hereby and forever excluded.</small></p> <p><small>Copyright permits this map to be used for purposes permitted by the Copyright Act 1968, reproduction by any means (photographic, electronic, mechanical, recording or otherwise) is prohibited without the prior written permission of the Department of Natural Resources, Mines & Energy.</small></p> <p><small>All enquiries: The M&E Paper, Topographic Data, Mapping, Department of Natural Resources, Mines & Energy, GPO Box 2451, Brisbane, QLD 4001.</small></p> <p><small>Produced by the Department of Natural Resources, Mines & Energy. © The State Of Queensland (Department of Natural Resources, Mines & Energy) January 2019.</small></p>	 <p>1:2,000</p> <p><small>0 0.01 0.02 0.03 0.04 Kilometres</small></p> <p><small>Map Projection: GDA 1984</small></p>	 <p>SHEET KEY</p>
-------------------------------------------------------------------------------------------------------------------------------------------------------------------------------------------------------------------------------------------------------------------------------------------------------------------------------------------------------------------------------------------------------------------------------------------------------------------------------------------------------------------------------------------------------------------------------------------------------------------------------------------------------------------------------------------------------------------	----------------------------------------------------------------------------------------------------------------------------------------------------------------------------------------------------------------------------------------------------------------------------------------------------------------------------------------------------------------------------------------------------------------------------------------------------------------------------------------------------------------------------------------------------------------------------------------------------------------------------------------------------------------------------------------------------------------------------------------------------------------------------------------------------------------------------------------------------------------------------------------------------------------------------------------------------------------------------------------------------------------------------------------------------------------------------------------------------------------------------------------------------------------------------------------------------------------------------------------------------------------------------------------------------------------------------------------------------------------------------------------------------------------------------------------------------------------------------------------------------------------------------------------------------------------------------------------------------------------------------------------------------------------------------------------------------------------------------------------------------------------------------------------------------------------------------------------------------------------------------------------------------------------	-----------------------------------------------------------------------------------------------------------------------------------------------------------------------------------------------------------------------	---------------------------------------------------------------------------------------------------------------

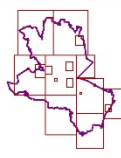

Document Path: K:\CLAIMMAP\2014\QCD2014_002_Gulngay_People\Determination_Map\MXD\QCD14_02_Gulngay_People_A3P_Determination_Mapbook_20181129.mxd

NATIVE TITLE DETERMINATION		
QUD308/2014 Gulngay People (QC2014/002) Sheet 4 of 26		
<p>LEGEND</p> <ul style="list-style-type: none"> Exclusive Native Title Non-exclusive Native Title External boundary DCDB 	<p>Copyright: Land Tenure Information obtained from the Digital Cadastre Data Base (June 2018), Department of Natural Resources, Mines & Energy, Brisbane. This (and any other) is the Department of Natural Resources, Mines & Energy should be consulted for verification of tenures.</p> <p>Boundary lines shown on this map have been obtained from available information. It is possible that errors and omissions may exist. While every care is taken to ensure the accuracy of this data, the Department of Natural Resources, Mines & Energy, and its contractors, make no representation or warranty as to the accuracy, reliability, completeness or suitability for any purpose and of social responsibility and all liability (including without limitation, liability in negligence) for any injuries, expenses, costs, damages (including indirect or consequential) and costs which might be incurred in reliance on the data being inaccurate or incomplete, is hereby and forever excluded.</p> <p>Copyright permits this publication. Use of the materials permitted by the Copyright Act 1968, reproduction by any means (photocopying, electronic, mechanical, recording or otherwise) is prohibited without the prior written permission of the Department of Natural Resources, Mines & Energy.</p> <p>All enquiries: The M&E Paper, Topographic Data, Mapping, Department of Natural Resources, Mines & Energy, GPO Box 2451, Brisbane, QLD 4001.</p> <p>Produced by the Department of Natural Resources, Mines & Energy. © The State Of Queensland (Department of Natural Resources, Mines & Energy) January 2019.</p>	 <p>1:1,500</p> <p>0 0.002500 0.002500 0.002500 0.002500 Kilometres</p> 
		 <p>SHEET KEY</p>

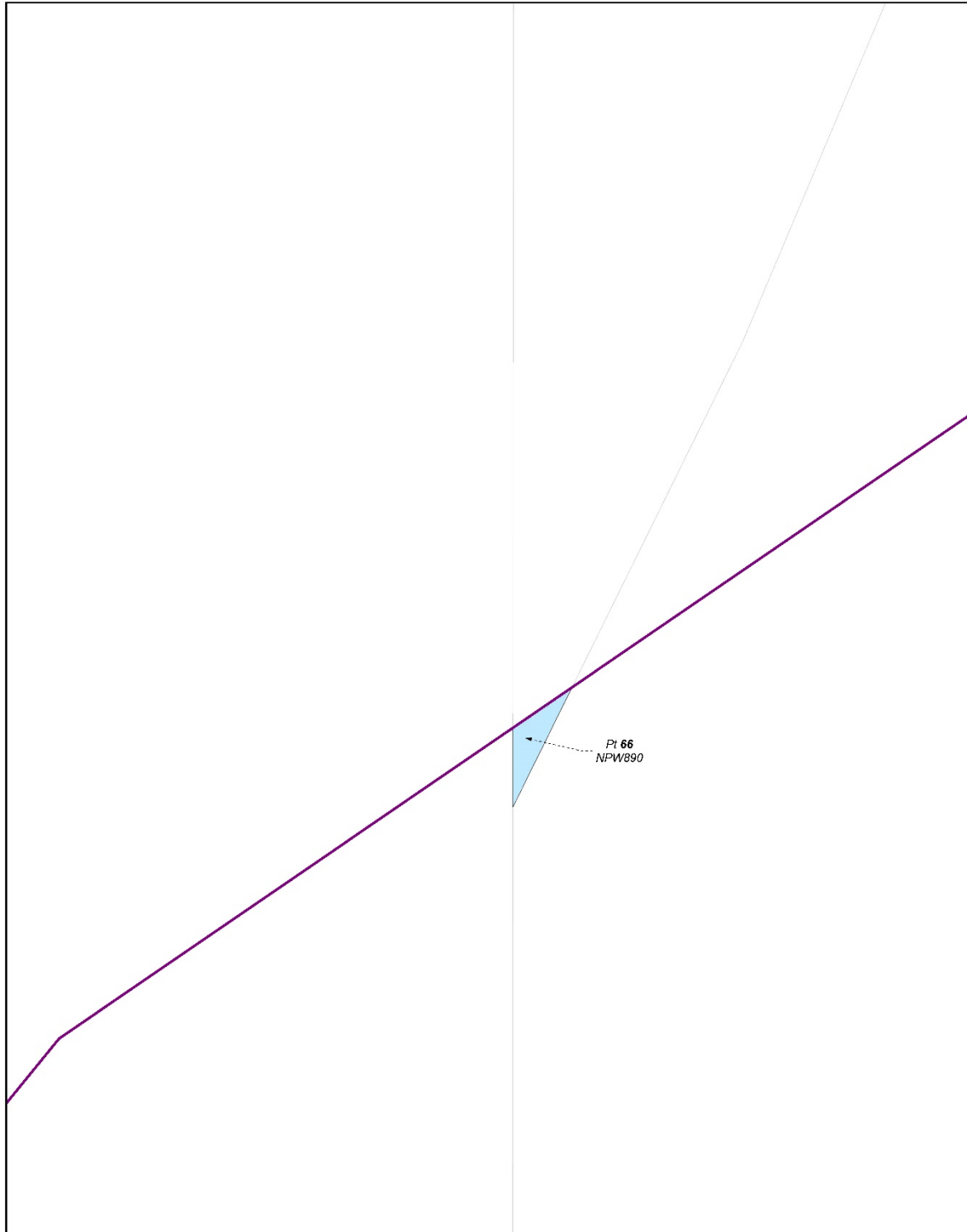

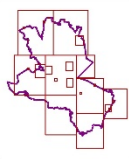

Document Path: K:\CLAIMMAP\2014\QCD2014_002_Gulgay_People\Determination_Map\MXD\QCD14_02_Gulgay_People_A3P_Determination_Mapbook_20181129.mxd

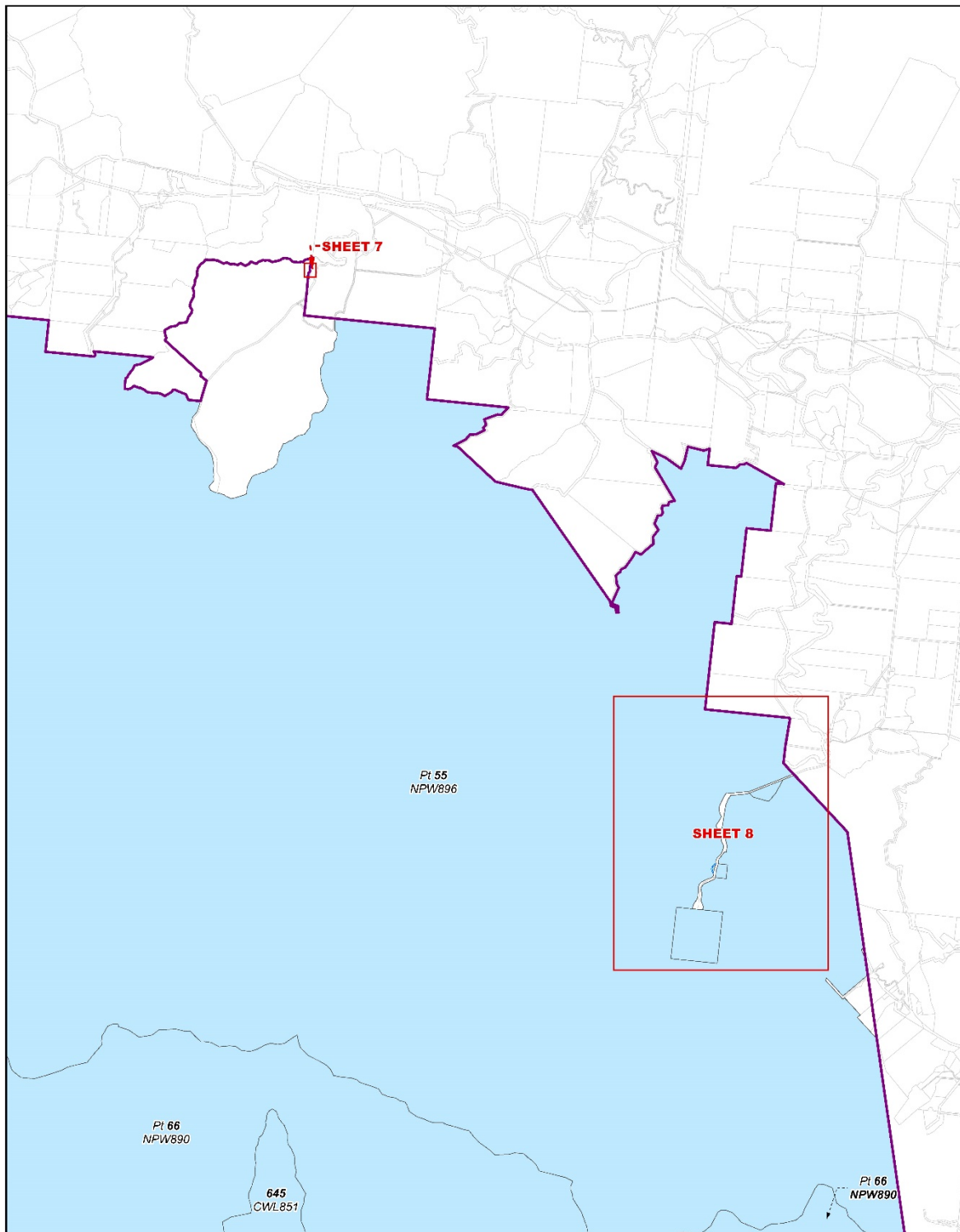
NATIVE TITLE DETERMINATION		
QUD308/2014 Gulgay People (QC2014/002) Sheet 5 of 26		
<p><small>Completion: Land Tenure Information obtained from the Digital Cadastre Data Base (June 2018), Department of Natural Resources, Mines & Energy, Brisbane. This (and any other) information is the Department of Natural Resources, Mines & Energy should be consulted for verification of tenures.</small></p> <p><small>From the names shown on this map have been obtained from available information. It is possible that errors and omissions may exist. While every care is taken to ensure the accuracy of this data, the Department of Natural Resources, Mines & Energy, and its contractors, make no representation or warranty as to the accuracy, reliability, completeness or suitability of any data for any purpose and of social responsibility and all liability (including without limitation, liability in negligence) for any injury, expenses, costs, damages (including indirect or consequential) and costs which might be incurred in reliance on the data is hereby excluded to the maximum extent permitted by law.</small></p> <p><small>Copyright remains the sole property of the Commonwealth of Australia. All rights reserved. No part of this publication may be reproduced, stored in a retrieval system, or transmitted in any form or by any means, electronic, mechanical, recording or otherwise, without the prior written permission of the Department of Natural Resources, Mines & Energy.</small></p> <p><small>All enquiries: The Maps, Topographic Data, Imagery & Mapping, Department of Natural Resources, Mines & Energy, GPO Box 2451, Brisbane, QLD 4001.</small></p> <p style="text-align: center;"><small>Produced by the Department of Natural Resources, Mines & Energy, © The State Of Queensland (Department of Natural Resources, Mines & Energy) January 2019.</small></p>		
<p>LEGEND</p> <ul style="list-style-type: none"> Exclusive Native Title Non-exclusive Native Title External boundary DCDB 	 <p>1:500</p> <p><small>0 00020 008 00750 01 Kilometres</small></p> <p><small>Map Projection: GDA 1984</small></p>	 <p style="text-align: center;">SHEET KEY</p>

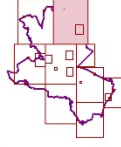

Document Path: K:\CLAIMMAP\2014\QCD2014_002_Gulguy People\Determination_Map\MXD\QCD14_02_Gulguy People_ASP_Determination_Mapbook_20181129.mxd

NATIVE TITLE DETERMINATION		
QUD308/2014 Gulguy People (QC2014/002) Sheet 6 of 26		
<p><small>Copyright: Land Tenure Information obtained from the Digital Cadastre Data Base (June 2018), Department of Natural Resources, Mines & Energy, Brisbane. The Land Register is the Department of Natural Resources, Mines & Energy should be consulted for verification of tenures.</small></p> <p><small>Frontier names shown on this map have been obtained from available information. It is possible that errors and omissions may exist. While every care is taken to ensure the accuracy of this data, the Department of Natural Resources, Mines & Energy, and/or its contractors do not accept any responsibility for any errors, omissions, inaccuracies, or any damages (including indirect or consequential) or costs which may be incurred by the user in relying on this data being accurate or complete, in any way or for any reason.</small></p> <p><small>Copyright permits this map to be used for purposes permitted by the Copyright Act 1968, reproduction by any means (photographic, electronic, mechanical, recording or otherwise) is prohibited without the prior written permission of the Department of Natural Resources, Mines & Energy. All enquiries: The Map Server, Topographic Data, Mapping, Department of Natural Resources, Mines & Energy, GPO Box 2451, Brisbane, QLD 4001.</small></p> <p style="text-align: center;"><small>Produced by the Department of Natural Resources, Mines & Energy. © The State Of Queensland (Department of Natural Resources, Mines & Energy) January 2019.</small></p>		
<p>LEGEND</p> <ul style="list-style-type: none"> Exclusive Native Title Non-exclusive Native Title External boundary DCDB 	<p style="text-align: center;">  1:45,000  <small>0 0.25 0.5 0.75 1 kilometers</small> </p>	<p style="text-align: center;">SHEET KEY</p> 

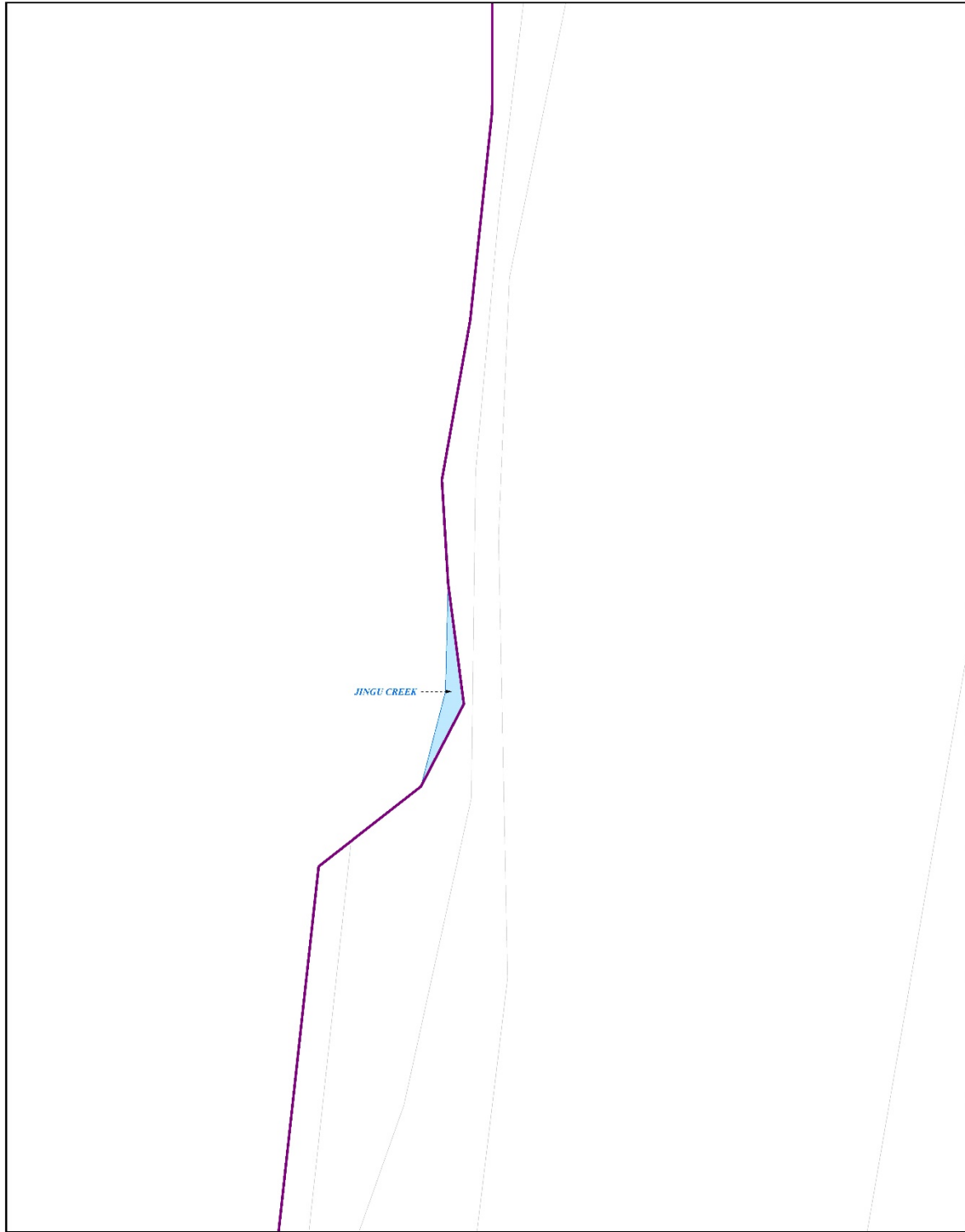

Document Path: K:\CLAIMMAP\2014\QCD2014_002_Gulngay_People\Determination_Map\MXD\QCD14_02_Gulngay_People_A3P_Determination_Mapbook_20181129.mxd

NATIVE TITLE DETERMINATION

QUD308/2014 Gulngay People (QC2014/002) Sheet 7 of 26

LEGEND

- Exclusive Native Title
- Non-exclusive Native Title
- External boundary
- DCDB

Copyright: Land Tenure Information obtained from the Digital Cadastre Data Base (June 2018), Department of Natural Resources, Mines & Energy, Brisbane. This (and any other) information is the Department of Natural Resources, Mines & Energy should be consulted for verification of tenures.

From the names shown on this map have been obtained from available information. It is possible that errors and omissions may exist. While every care is taken to ensure the accuracy of this data, the Department of Natural Resources, Mines & Energy, and its contractors, make no representation or warranty as to the accuracy, reliability, completeness or suitability of any data for any purpose and of social responsibility and all liability (including without limitation, liability in negligence) for any loss, expenses, costs, damages (including indirect or consequential) and costs which might be incurred in connection with the data being inaccurate or incomplete, in any way or for any reason.

Copyright permits this publication. Use of the materials permitted by the Copyright Act 1968, reproduction by any means (photocopying, electronic, mechanical, recording or otherwise) is prohibited without the prior written permission of the Department of Natural Resources, Mines & Energy. All enquiries: The Mapping, Topographic Data, Imagery & Mapping, Department of Natural Resources, Mines & Energy, GPO Box 2451, Brisbane, QLD 4001.

Produced by the Department of Natural Resources, Mines & Energy,
 © The State Of Queensland (Department of Natural Resources, Mines & Energy) January 2019.



1:500

0 00026 008 00750 01
Kilometres

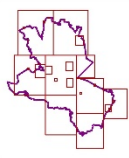

SHEET KEY

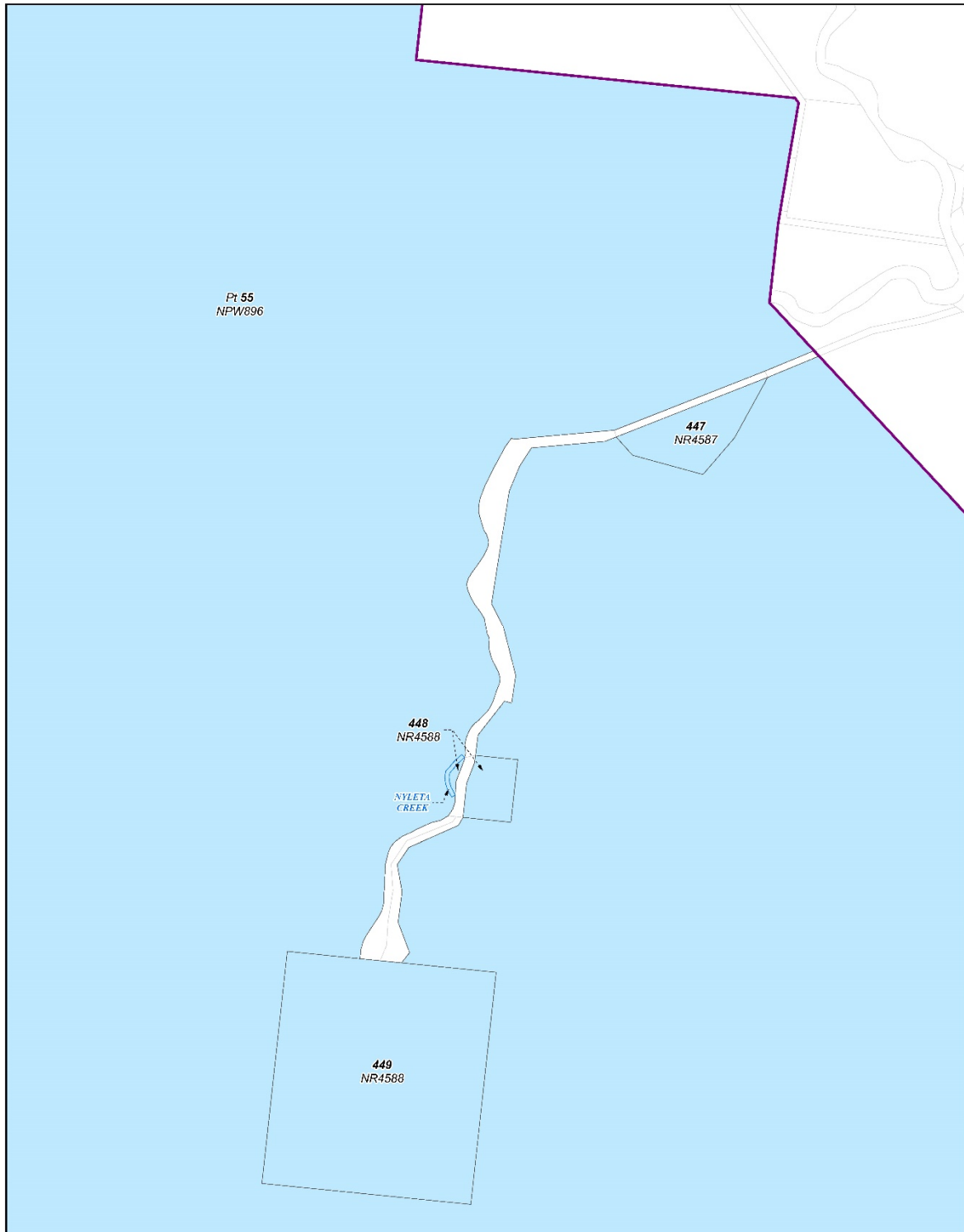

Document Path: K:\CLAIMMAP\2014\QCD2014_003 Gulngay People\Determination_Map\MXD\QCD14_02_Gulngay_People_A3P_Determination_Mapbook_20181129.mxd

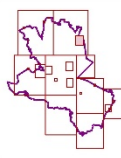
<p>LEGEND</p> <ul style="list-style-type: none"> Exclusive Native Title Non-exclusive Native Title External boundary DCDB 	<p>NATIVE TITLE DETERMINATION</p> <p>QUD308/2014 Gulngay People (QC2014/002) Sheet 8 of 26</p> <p><small>Copyright: Land Tenure Information obtained from the Digital Cadastre Data Base (June 2018), Department of Natural Resources, Mines & Energy, Brisbane. The (and any) in the Department of Natural Resources, Mines & Energy should be consulted for verification of tenures.</small></p> <p><small>From the names shown on this map have been obtained from available information. It is possible that errors and omissions may exist. While every care is taken to ensure the accuracy of this data, the Department of Natural Resources, Mines & Energy, and its contractors, do not accept any responsibility for the accuracy, reliability, completeness or suitability of any data for any purpose and do not accept any liability (including without limitation, liability in negligence) for any loss, expenses, costs, damages (including indirect or consequential), or costs which might be incurred in reliance on the data being inaccurate or incomplete, in any way or for any reason.</small></p> <p><small>Copyright permits the use of the names shown for the purposes permitted by the Copyright Act 1968, reproduction by any means (photocopying, electronic, mechanical, recording or otherwise) is prohibited without the prior written permission of the Department of Natural Resources, Mines & Energy.</small></p> <p><small>All enquiries: The Maps and Topographic Data, Mapping, Department of Natural Resources, Mines & Energy, GPO Box 2451, Brisbane, QLD 4001.</small></p> <p><small>Produced by the Department of Natural Resources, Mines & Energy. © The State Of Queensland (Department of Natural Resources, Mines & Energy) January 2019.</small></p>	 <p>1:10,000</p> <p><small>0 0.05 0.1 0.15 0.2 Kilometres</small></p> <p><small>Map Projection: GDA 1984</small></p>	 <p>SHEET KEY</p>
--------------------------------------------------------------------------------------------------------------------------------------------------------------------------------------------------------------------------------------------------------------------------------------------------------------------------------------------------------------------------------------------------------------------------------------------------------------------------------------------------------------------------------------------------------------------------------------------------------------------------------------------------------------------------------------------------------------------	---------------------------------------------------------------------------------------------------------------------------------------------------------------------------------------------------------------------------------------------------------------------------------------------------------------------------------------------------------------------------------------------------------------------------------------------------------------------------------------------------------------------------------------------------------------------------------------------------------------------------------------------------------------------------------------------------------------------------------------------------------------------------------------------------------------------------------------------------------------------------------------------------------------------------------------------------------------------------------------------------------------------------------------------------------------------------------------------------------------------------------------------------------------------------------------------------------------------------------------------------------------------------------------------------------------------------------------------------------------------------------------------------------------------------------------------------------------------------------------------------------------------------------------------------------------------------------------------------------------------------------------------------------------------------------------------------------------------------------------------------------------------------------------------------------------------------------------------------------------------	----------------------------------------------------------------------------------------------------------------------------------------------------------------------------------------------------------------------	---------------------------------------------------------------------------------------------------------------

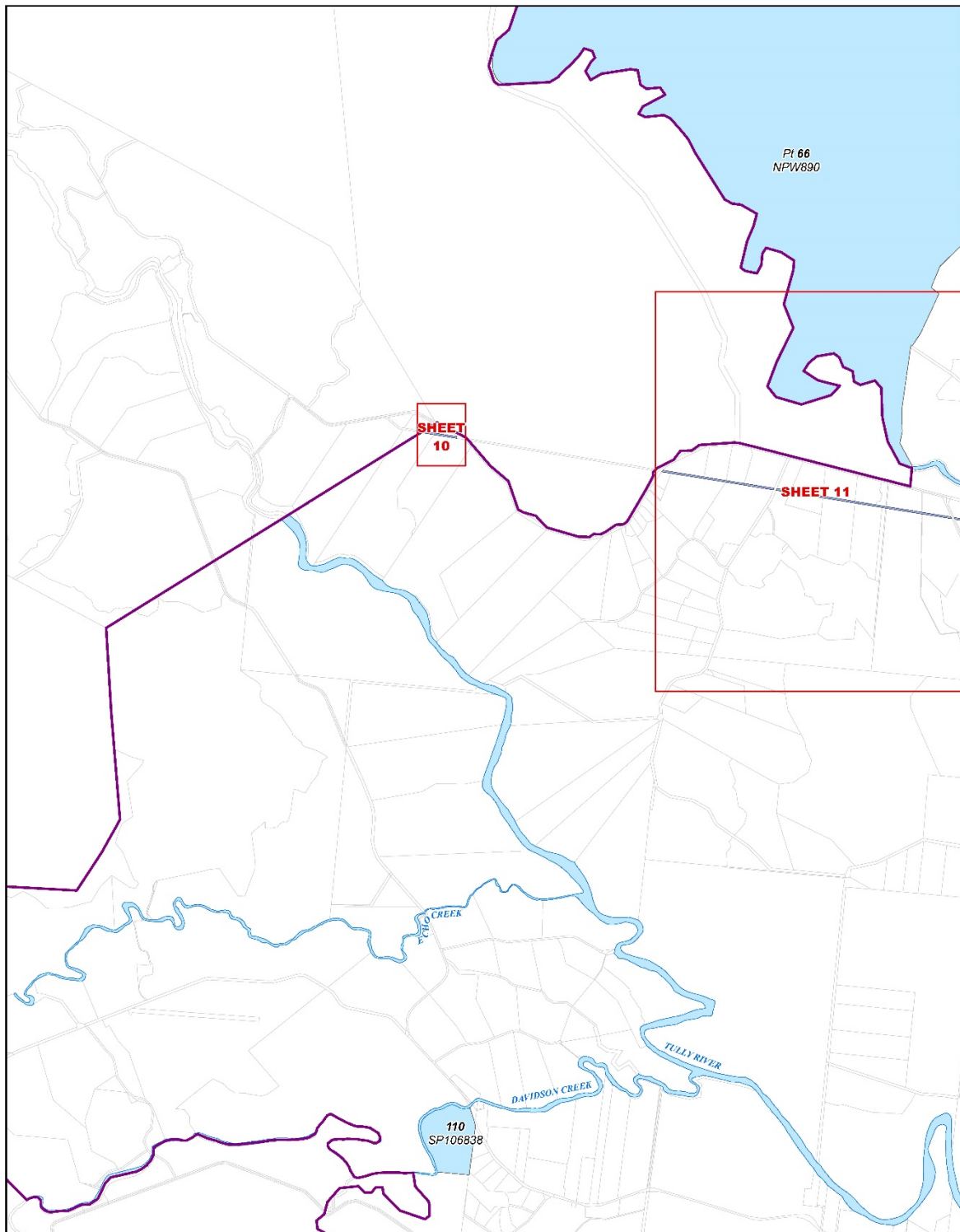

Document Path: K:\CLAIMMAP\2014\QCD2014_002 Gulngay People\Determinaion_Map\MXD\QCD2014_002 Gulngay People_A3P_Determination_Mapbook_20181129.mxd

NATIVE TITLE DETERMINATION

QUD308/2014 Gulngay People (QC2014/002) Sheet 9 of 26

LEGEND

- Exclusive Native Title
- Non-exclusive Native Title
- External boundary
- DCDB

Copyright: Land Tenure Information obtained from the Digital Cadastre Data Base (June 2018), Department of Natural Resources, Mines & Energy, Brisbane. This (and any other) information is the Department of Natural Resources, Mines & Energy should be consulted for verification of tenures.

From the names shown on this map have been obtained from available information. It is possible that errors and omissions may exist. While every care is taken to ensure the accuracy of this data, the Department of Natural Resources, Mines & Energy, and/or its contractors do not accept any liability for any inaccuracies, errors, omissions or damages of any kind, or for any loss or damage, or for any liability, including without limitation, liability in negligence for any injuries, expenses, costs, damages (including indirect or consequential) and costs which may be incurred by any person in reliance on the data being inaccurate or incomplete, in any way or for any reason.

Copyright permits this map to be used for purposes permitted by the Copyright Act 1968, reproduction by any means (photocopying, electronic, mechanical, recording or otherwise) is prohibited without the prior written permission of the Department of Natural Resources, Mines & Energy.

All enquiries: The Map Server, Topographic Data, Mapping, Department of Natural Resources, Mines & Energy, GPO Box 2451, Brisbane, QLD 4001.

Produced by the Department of Natural Resources, Mines & Energy,
 © The State Of Queensland (Department of Natural Resources, Mines & Energy) January 2019.



1:40,000

0 0.2 0.4 0.6 0.8
Kilometres

Map Projection: GDA 1984

SHEET KEY

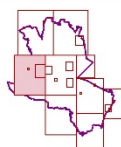

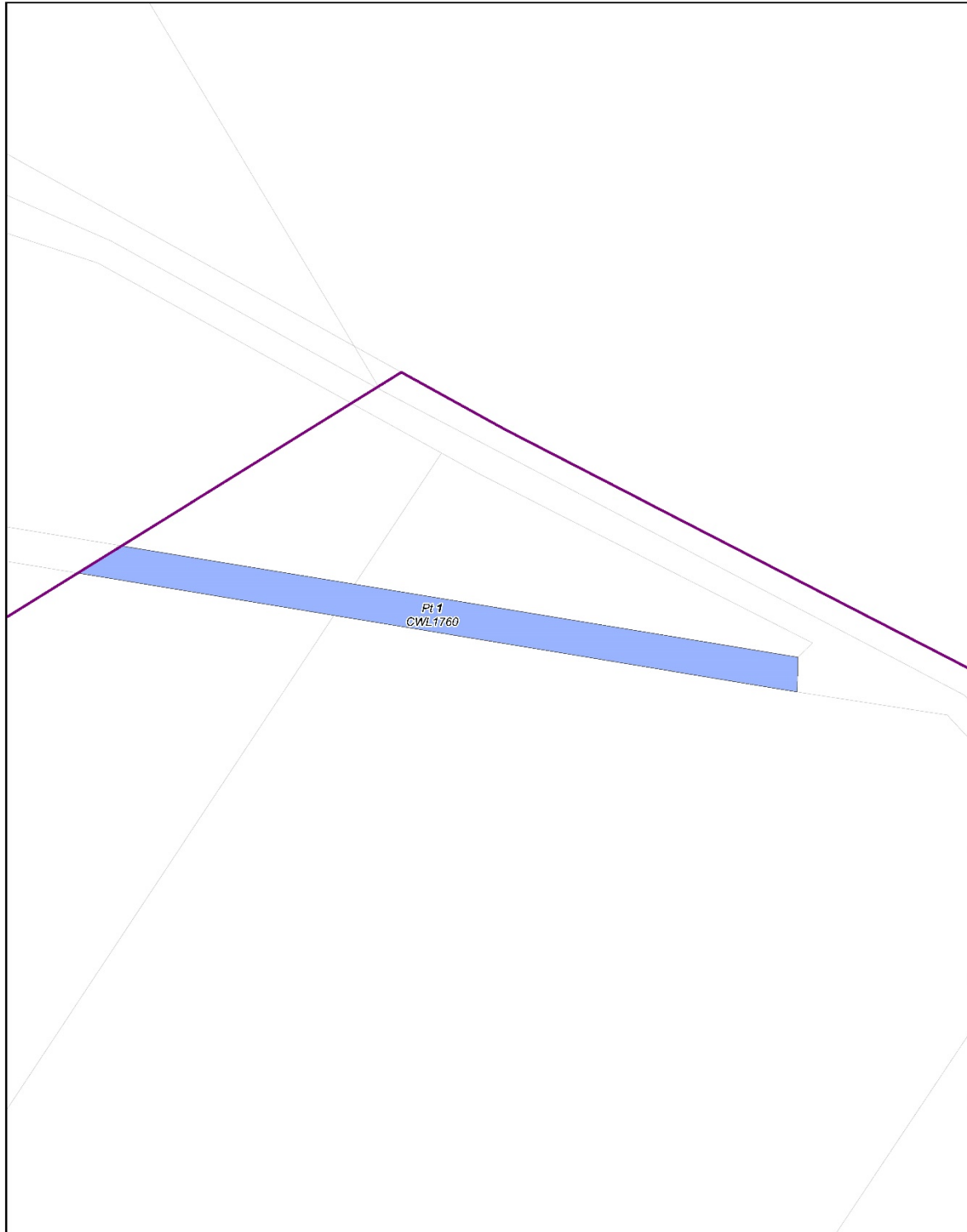

Document Path: K:\CLAIMMAP\2014\QCD2014_003_Gulguy_People\People\Determination_Map\MXD\QCD14_02_Gulguy_People_A3P_Determination_Mapbook_20181129.mxd

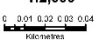
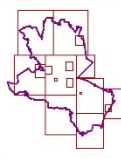
NATIVE TITLE DETERMINATION		
QUD308/2014 Gulguy People (QC2014/002) Sheet 10 of 26		
<p>LEGEND</p> <ul style="list-style-type: none"> Exclusive Native Title Non-exclusive Native Title External boundary DCDB 	<p>Copyright: Land Tenure Information obtained from the Digital Cadastre Data Base (June 2018), Department of Natural Resources, Mines & Energy, Brisbane. The Land Registry is the Department of Natural Resources, Mines & Energy should be consulted for verification of tenures.</p> <p>From: names shown on this map have been obtained from available information. It is possible that errors and omissions may exist. While every care is taken to ensure the accuracy of this data, the Department of Natural Resources, Mines & Energy, and/or its contractors do not accept any responsibility for any errors, omissions, inaccuracies, or damages (including indirect or consequential) and costs which might be incurred in reliance on the data being inaccurate or incomplete, in any way or for any reason.</p> <p>Copyright remains the sole property of the State of Queensland for the purposes permitted by the Copyright Act 1969, reproduction by any means (photocopying, electronic, mechanical, recording or otherwise) is prohibited without the prior written permission of the Department of Natural Resources, Mines & Energy.</p> <p>All enquiries: The Maps, Topographic Data, Mapping & Mapping, Department of Natural Resources, Mines & Energy, GPO Box 2451, Brisbane, QLD 4001</p> <p>Produced by the Department of Natural Resources, Mines & Energy. © The State Of Queensland (Department of Natural Resources, Mines & Energy) January 2019.</p>	 <p>1:2,000</p> <p>0 0.01 0.02 0.03 0.04 Kilometres</p>  <p>Map Projection: GDA 1984</p>  <p>SHEET KEY</p>

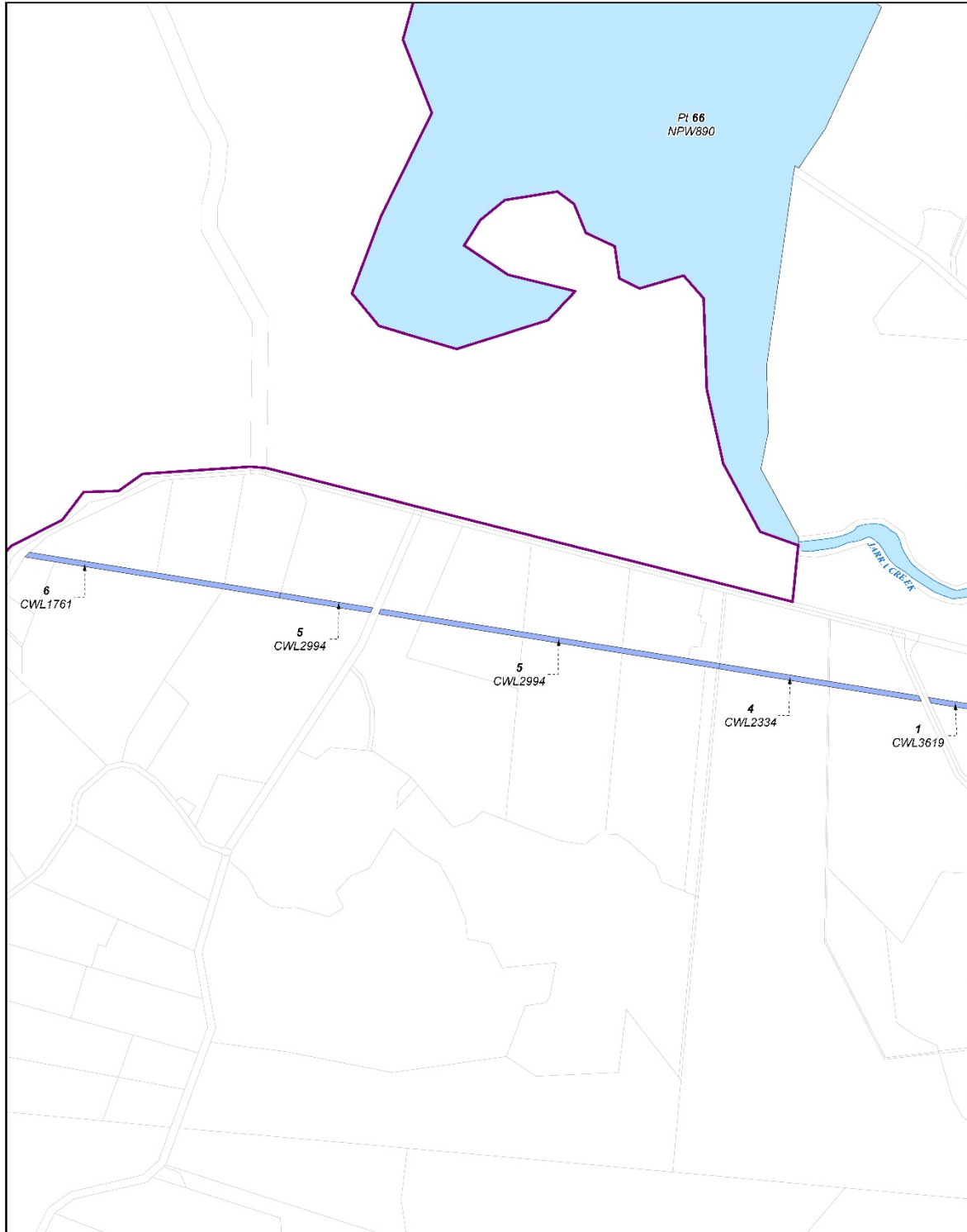

Document Path: K:\CLAIMMAP\2014\QCD2014_003 Gulngay People\Determination_Map\MXD\QCD14_02_Gulngay_People_A3P_Determination_Mapbook_20181129.mxd

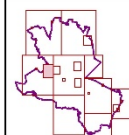
<p>LEGEND</p> <ul style="list-style-type: none"> Exclusive Native Title Non-exclusive Native Title External boundary DCDB 	<p>NATIVE TITLE DETERMINATION</p> <p>QUD308/2014 Gulngay People (QC2014/002) Sheet 11 of 26</p> <p><small>Copyright: Land Tenure Information obtained from the Digital Cadastre Data Base (June 2018), Department of Natural Resources, Mines & Energy, Brisbane. This (and any other) information is the property of the Department of Natural Resources, Mines & Energy and should be used for the purposes of the intended use only.</small></p> <p><small>From the names shown on this map have been obtained from available information. It is possible that errors and omissions may exist. While every care is taken to ensure the accuracy of this data, the Department of Natural Resources, Mines & Energy, and its contractors, make no representation or warranty as to the accuracy, reliability, completeness or suitability of any data for any purpose and of so far as a person's liability and all liability (including without limitation, liability in negligence) for any injury, expenses, costs, damages (including indirect or consequential) and costs which might be incurred in connection with the data being inaccurate or incomplete, in any way or for any reason.</small></p> <p><small>Copyright permits the reproduction of this map for non-commercial purposes provided that the Department of Natural Resources, Mines & Energy, is acknowledged in the reproduction. All other rights are reserved. Reproduction of this map for any other purpose without the prior written permission of the Department of Natural Resources, Mines & Energy is prohibited.</small></p> <p><small>All enquiries: The Maps and Topographic Data, Mapping, Department of Natural Resources, Mines & Energy, GPO Box 2451, Brisbane, QLD 4001</small></p> <p><small>Produced by the Department of Natural Resources, Mines & Energy. © The State Of Queensland (Department of Natural Resources, Mines & Energy) January 2019.</small></p>	 <p>1:13,000</p> <p><small>0 0.065 0.13 0.195 0.26 Kilometres</small></p> <p><small>Map Projection: GDA 1984</small></p>	 <p>SHEET KEY</p>
-------------------------------------------------------------------------------------------------------------------------------------------------------------------------------------------------------------------------------------------------------------------------------------------------------------------------------------------------------------------------------------------------------------------------------------------------------------------------------------------------------------------------------------------------------------------------------------------------------------------------------------------------------------------------------------------------------------------	--------------------------------------------------------------------------------------------------------------------------------------------------------------------------------------------------------------------------------------------------------------------------------------------------------------------------------------------------------------------------------------------------------------------------------------------------------------------------------------------------------------------------------------------------------------------------------------------------------------------------------------------------------------------------------------------------------------------------------------------------------------------------------------------------------------------------------------------------------------------------------------------------------------------------------------------------------------------------------------------------------------------------------------------------------------------------------------------------------------------------------------------------------------------------------------------------------------------------------------------------------------------------------------------------------------------------------------------------------------------------------------------------------------------------------------------------------------------------------------------------------------------------------------------------------------------------------------------------------------------------------------------------------------------------------------------------------------------------------------------------------------------------------------------------------------------------------------------------------------------------------------------------------------------------------------------------------------------------------------------------------------------------------	--------------------------------------------------------------------------------------------------------------------------------------------------------------------------------------------------------------------------	---------------------------------------------------------------------------------------------------------------

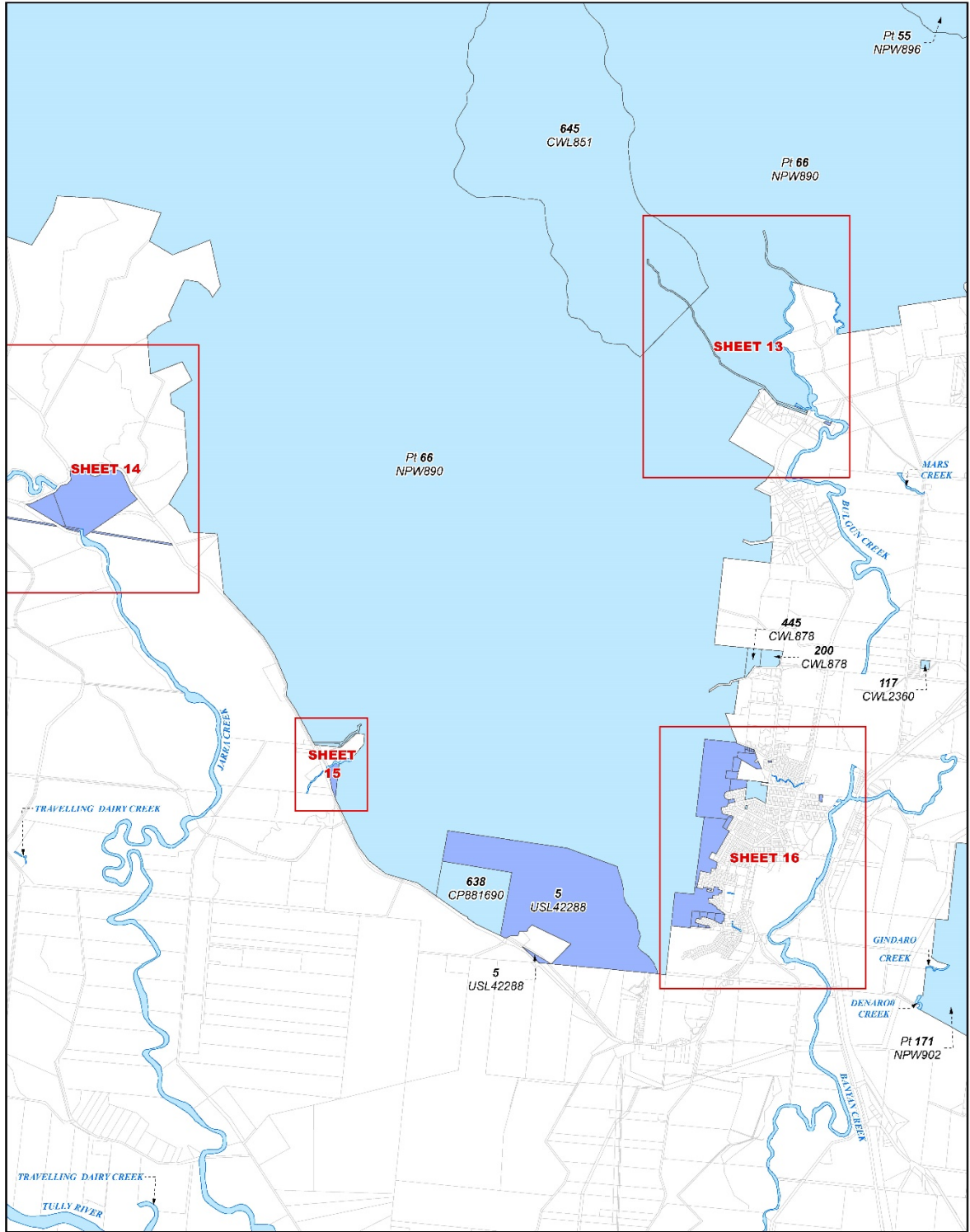

Document Path: K:\CLAIMMAP\2014\QCD2014_003_Gulgay_People\Determination_Map\MXD\QCD14_02_Gulgay_People_A3P_Determination_Mapbook_20181129.mxd

<p>LEGEND</p> <ul style="list-style-type: none"> Exclusive Native Title Non-exclusive Native Title External boundary DCDB 	<p>NATIVE TITLE DETERMINATION</p> <p>QUD308/2014 Gulgay People (QC2014/002) Sheet 12 of 26</p> <p><small>Copyright: Land Tenure Information obtained from the Digital Cadastre Data Base (June 2018), Department of Natural Resources, Mines & Energy, Brisbane. The land registry is the Department of Natural Resources, Mines & Energy should be consulted for verification of tenures.</small></p> <p><small>From names shown on this map have been obtained from available information. It is possible that errors and omissions may exist. While every care is taken to ensure the accuracy of this data, the Department of Natural Resources, Mines & Energy, and/or its contractors do not accept any liability for any loss, expenses, costs, damages (including indirect or consequential) or costs which may be incurred by any person in reliance on the data being inaccurate or incomplete. In any case of the contrary.</small></p> <p><small>Copyright remains the sole property of the purposes permitted by the Copyright Act 1968, reproduction by any means (photocopying, electronic, mechanical, recording or otherwise) is prohibited without the prior written permission of the Department of Natural Resources, Mines & Energy.</small></p> <p><small>All enquiries: The Mapping, Topographic Data, Imagery & Mapping, Department of Natural Resources, Mines & Energy, GPO Box 2451, Brisbane, QLD 4001.</small></p> <p><small>Produced by the Department of Natural Resources, Mines & Energy. © The State of Queensland (Department of Natural Resources, Mines & Energy) January 2019.</small></p>	<p>1:40,000</p> <p>0 0.2 0.4 0.6 0.8 Kilometres</p> <p>Map Projection: GDA 1984</p>	<p>SHEET KEY</p>
-------------------------------------------------------------------------------------------------------------------------------------------------------------------------------------------------------------------------------------------------------------------------------------------------------------------------------------------------------------------------------------------------------------------------------------------------------------------------------------------------------------------------------------------------------------------------------------------------------------------------------------------------------------------------------------------------------------------	-------------------------------------------------------------------------------------------------------------------------------------------------------------------------------------------------------------------------------------------------------------------------------------------------------------------------------------------------------------------------------------------------------------------------------------------------------------------------------------------------------------------------------------------------------------------------------------------------------------------------------------------------------------------------------------------------------------------------------------------------------------------------------------------------------------------------------------------------------------------------------------------------------------------------------------------------------------------------------------------------------------------------------------------------------------------------------------------------------------------------------------------------------------------------------------------------------------------------------------------------------------------------------------------------------------------------------------------------------------------------------------------------------------------------------------------------------------------------------------------------------------------------------------------------------------------------------------------------------------------------------------------------------------------------------------------------	------------------------------------------------------------------------------------------------	-------------------------



Document Path: K:\CLAIMMAP\2014\QCD2014_003_Gulgay_People\Determination_Map\MXD\QCD14_02_Gulgay_People_A3P_Determination_Mapbook_20181129.mxd

NATIVE TITLE DETERMINATION

QUD308/2014 Gulgay People (QC2014/002) Sheet 13 of 26

LEGEND

- Exclusive Native Title
- Non-exclusive Native Title
- External boundary
- DCDB

Copyright: Land Tenure Information obtained from the Digital Cadastre Data Base (June 2018), Department of Natural Resources, Mines & Energy, Brisbane. This (and any other) is the Department of Natural Resources, Mines & Energy should be consulted for verification of tenures.

From the names shown on this map have been obtained from available information. It is possible that errors and omissions may exist. While every care is taken to ensure the accuracy of this data, the Department of Natural Resources, Mines & Energy, and/or its contractors, do not accept any responsibility for any errors, omissions, inaccuracies, or any damages (including indirect or consequential) or costs which may be incurred by the data being inaccurate or incomplete. In any case of any error.

Copyright permits this map to be used for purposes permitted by the Copyright Act 1968, reproduction by any means (photocopying, electronic, mechanical, recording or otherwise) is prohibited without the prior written permission of the Department of Natural Resources, Mines & Energy.

All enquiries: The Maps, Topographic Data, Mapping, Department of Natural Resources, Mines & Energy, GPO Box 2451, Brisbane, QLD 4001.

Produced by the Department of Natural Resources, Mines & Energy.
 © The State Of Queensland (Department of Natural Resources, Mines & Energy) January 2019.



1:8,500

0 0.04 0.08 0.12 0.16
Kilometres

Map Projection: GDA 1984

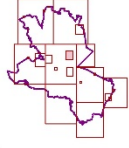

SHEET KEY



Document Path: K:\CLAIMMAP\2014\QCD2014_003_Gulgay_People\Determination_Map\MXD\QCD14_02_Gulgay_People_A3P_Determination_Mapbook_20181129.mxd

NATIVE TITLE DETERMINATION

QUD308/2014 Gulgay People (QC2014/002) Sheet 14 of 26

LEGEND

- Exclusive Native Title
- Non-exclusive Native Title
- External boundary
- DCDB

Copyright: Land Tenure Information obtained from the Digital Cadastre Data Base (June 2014), Department of Natural Resources, Mines & Energy, Brisbane. This (and any other) information is the property of the Department of Natural Resources, Mines & Energy and should be consulted for verification of tenures.

Frontier names shown on this map have been obtained from available information. It is possible that errors and omissions may exist. While every care is taken to ensure the accuracy of this data, the Department of Natural Resources, Mines & Energy, and/or its contractors do not accept any responsibility for any errors, omissions, inaccuracies, or any consequences of any use of this data for any purpose and of so far as a responsibility and/or liability (including without limitation, liability in negligence) for any loss, expenses, costs, damages (including indirect or consequential) and costs which may be incurred in reliance on the data being inaccurate or incomplete, in any way or for any reason.

Copyright remains the sole property of the Department of Natural Resources, Mines & Energy, Queensland (photocopying, electronic, mechanical, recording or otherwise) is prohibited without the prior written permission of the Department of Natural Resources, Mines & Energy. All enquiries to: The Mapping, Topographic Data, Imagery & Mapping, Department of Natural Resources, Mines & Energy, GPO Box 2451, Brisbane, QLD 4001.

Produced by the Department of Natural Resources, Mines & Energy,
 © The State Of Queensland (Department of Natural Resources, Mines & Energy) January 2019.



1:8,000

0 0.04 0.08 0.12 0.16
Kilometres

Map Projection: GDA 1984

SHEET KEY

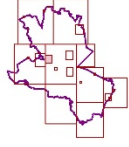

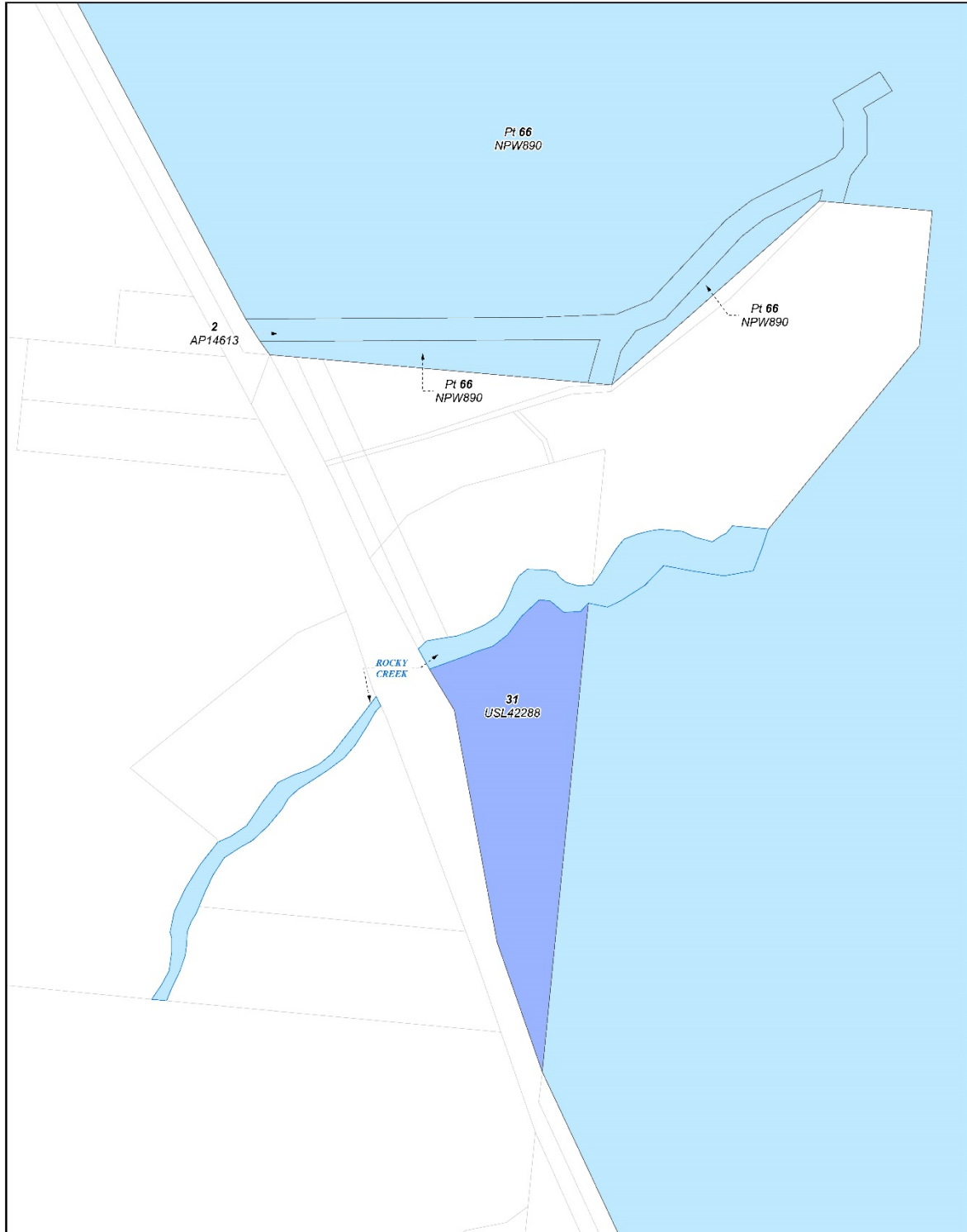

Document Path: K:\CLAIMMAP\2014\QCD2014_003 Gulngay People\Determination_Map\MXD\QCD14_02_Gulngay_People_A3P_Determination_Mapbook_20181129.mxd

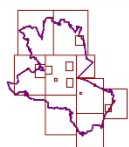
<p>LEGEND</p> <ul style="list-style-type: none"> Exclusive Native Title Non-exclusive Native Title External boundary DCDB 	<p>NATIVE TITLE DETERMINATION</p> <p>QUD308/2014 Gulngay People (QC2014/002) Sheet 15 of 26</p> <p><small>Completion: Land Tenure Information obtained from the Digital Cadastre Data Base (June 2018), Department of Natural Resources, Mines & Energy, Brisbane. The Land Registry is the Department of Natural Resources, Mines & Energy should be consulted for verification of tenures.</small></p> <p><small>Errors: Names shown on this map have been obtained from available information. It is possible that errors and omissions may exist. While every care is taken to ensure the accuracy of this data, the Department of Natural Resources, Mines & Energy, and/or its contractors do not accept any liability for any loss or damage arising from the use of this data, or any reliance on the accuracy, reliability, completeness or suitability of any data for any purpose and of course a responsibility for all liability (including without limitation, liability in negligence) for any loss, expenses, costs, damages (including indirect or consequential) and costs which might be incurred in connection therewith, in any way or for any reason.</small></p> <p><small>Copyright remains the sole property of the Commonwealth of Australia. All rights reserved. No part of this publication may be reproduced, stored in a retrieval system, or transmitted, in any form or by any means, electronic, mechanical, recording or otherwise, without the prior written permission of the Department of Natural Resources, Mines & Energy.</small></p> <p><small>All enquiries: The Maps, Topographic Data, Mapping, Department of Natural Resources, Mines & Energy, GPO Box 2451, Brisbane, QLD 4001</small></p> <p><small>Produced by the Department of Natural Resources, Mines & Energy. © The State Of Queensland (Department of Natural Resources, Mines & Energy) January 2019.</small></p>	 <p>1:3,000</p> <p><small>0 0.015 0.03 0.045 0.06 Kilometres</small></p> <p><small>Map Projection: GDA 1984</small></p>	 <p>SHEET KEY</p>
-------------------------------------------------------------------------------------------------------------------------------------------------------------------------------------------------------------------------------------------------------------------------------------------------------------------------------------------------------------------------------------------------------------------------------------------------------------------------------------------------------------------------------------------------------------------------------------------------------------------------------------------------------------------------------------------------------------------	-----------------------------------------------------------------------------------------------------------------------------------------------------------------------------------------------------------------------------------------------------------------------------------------------------------------------------------------------------------------------------------------------------------------------------------------------------------------------------------------------------------------------------------------------------------------------------------------------------------------------------------------------------------------------------------------------------------------------------------------------------------------------------------------------------------------------------------------------------------------------------------------------------------------------------------------------------------------------------------------------------------------------------------------------------------------------------------------------------------------------------------------------------------------------------------------------------------------------------------------------------------------------------------------------------------------------------------------------------------------------------------------------------------------------------------------------------------------------------------------------------------------------------------------------------------------------------------------------------------------------------------------------------------------------------------------------------------------------------------------------------------------------------------------------------------------------------------------------------------------------------------------------------------------------------------------------------------------------------------------	-------------------------------------------------------------------------------------------------------------------------------------------------------------------------------------------------------------------------	---------------------------------------------------------------------------------------------------------------

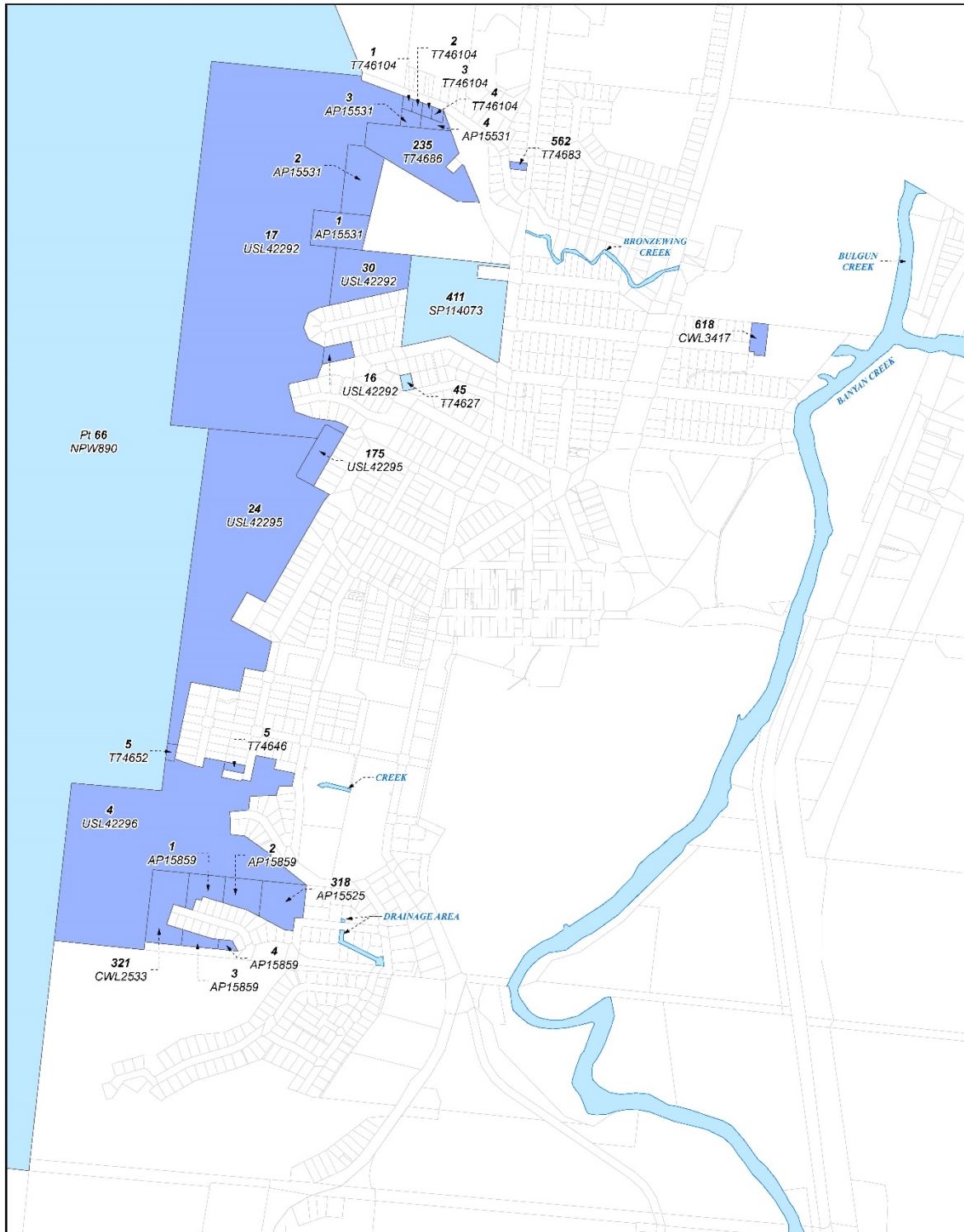

Document Path: K:\CLAIMMAP\2014\QCD2014_003_Gulgay_People\Determination_Map\MXD\QCD14_02_Gulgay_People_A3P_Determination_Mapbook_20181129.mxd

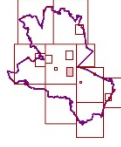
<p>LEGEND</p> <ul style="list-style-type: none"> Exclusive Native Title Non-exclusive Native Title External boundary DCDB 	<p>NATIVE TITLE DETERMINATION</p> <p>QUD308/2014 Gulgay People (QC2014/002) Sheet 16 of 26</p> <p><small>Copyright: Land Tenure Information obtained from the Digital Cadastre Data Base (June 2018), Department of Natural Resources, Mines & Energy, Brisbane. The land registry is the custodian of Natural Resources, Mines & Energy should be consulted for verification of tenures.</small></p> <p><small>From: names shown on this map have been obtained from available information. It is possible that errors and omissions may exist. While every care is taken to ensure the accuracy of this data, the Department of Natural Resources, Mines & Energy, and/or its contractors do not accept any responsibility for any errors or omissions, or for any consequences of reliance on this data. It is the user's responsibility to verify the accuracy, reliability, completeness or suitability of any data for any purpose and to seek a professional's advice if liability (including without limitation, liability in negligence) for any injuries, expenses, costs, damages (including indirect or consequential) and costs which may be incurred in reliance on the data being inaccurate or incomplete, is sought or for any reason.</small></p> <p><small>Copyright permits this data to be used for the purposes permitted by the Copyright Act 1968, reproduction by any means (photocopying, electronic, mechanical, recording or otherwise) is prohibited without the prior written permission of the Department of Natural Resources, Mines & Energy.</small></p> <p><small>All enquiries: The M&E Paper, Topographic Data, Mapping, Department of Natural Resources, Mines & Energy, GPO Box 2451, Brisbane, QLD 4001.</small></p> <p><small>Produced by the Department of Natural Resources, Mines & Energy. © The State Of Queensland (Department of Natural Resources, Mines & Energy) January 2019.</small></p>	 <p>1:8,500</p> <p><small>0 0.04 0.08 0.12 0.16 Kilometres</small></p> <p><small>Map Projection: GDA 1984</small></p>	 <p>SHEET KEY</p>
-------------------------------------------------------------------------------------------------------------------------------------------------------------------------------------------------------------------------------------------------------------------------------------------------------------------------------------------------------------------------------------------------------------------------------------------------------------------------------------------------------------------------------------------------------------------------------------------------------------------------------------------------------------------------------------------------------------------	--------------------------------------------------------------------------------------------------------------------------------------------------------------------------------------------------------------------------------------------------------------------------------------------------------------------------------------------------------------------------------------------------------------------------------------------------------------------------------------------------------------------------------------------------------------------------------------------------------------------------------------------------------------------------------------------------------------------------------------------------------------------------------------------------------------------------------------------------------------------------------------------------------------------------------------------------------------------------------------------------------------------------------------------------------------------------------------------------------------------------------------------------------------------------------------------------------------------------------------------------------------------------------------------------------------------------------------------------------------------------------------------------------------------------------------------------------------------------------------------------------------------------------------------------------------------------------------------------------------------------------------------------------------------------------------------------------------------------------------------------------------------------------------------------------------------------------------------------------------------------------------------------------------------------------------------------------------------------------------------------------------	------------------------------------------------------------------------------------------------------------------------------------------------------------------------------------------------------------------------------------	---------------------------------------------------------------------------------------------------------------

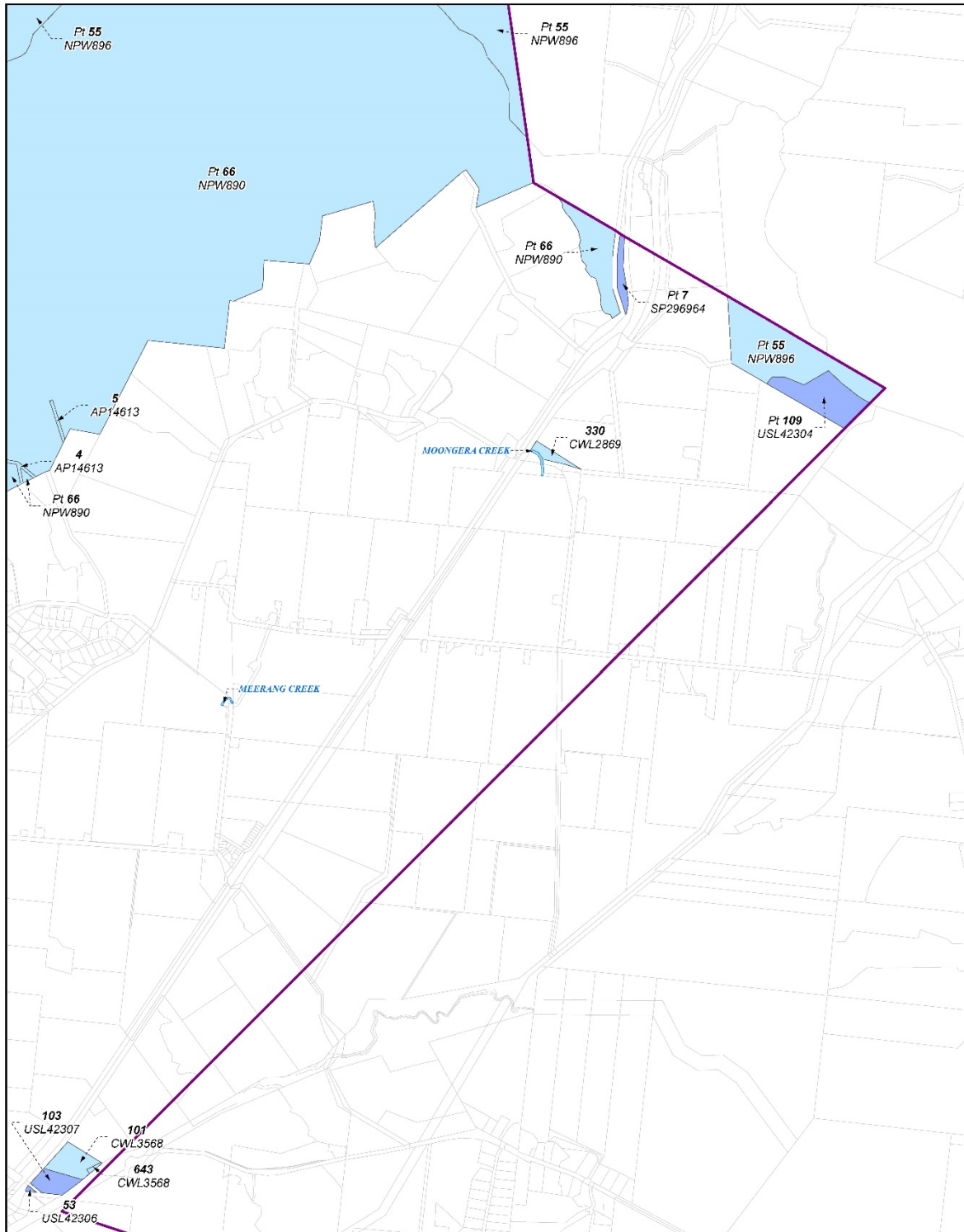

Document Path: K:\CLAIMMAP\2014\QCD2014_002_Gulgay_People\Determination_Map\MXD\QCD2014_02_Gulgay_People_A3P_Determination_Mapbook_20181129.mxd

NATIVE TITLE DETERMINATION

QUD308/2014 Gulgay People (QC2014/002) Sheet 17 of 26

LEGEND

- Exclusive Native Title
- Non-exclusive Native Title
- External boundary
- DCDB

Copyright: Land Tenure Information obtained from the Digital Cadastre Data Base (June 2018), Department of Natural Resources, Mines & Energy, Brisbane. This (and any other) is the Department of Natural Resources, Mines & Energy should be consulted for verification of tenures.

From the names shown on this map have been obtained from available information. It is possible that errors and omissions may exist. While every care is taken to ensure the accuracy of this data, the Department of Natural Resources, Mines & Energy, and/or its contractors do not accept any liability for any loss or damage, including consequential, arising from the use of this data for any purpose and/or for any reason. A responsible party should be consulted for all liability (including without limitation, liability in negligence) for any injuries, expenses, costs, damages (including indirect or consequential) and costs which may be incurred in reliance on the data being inaccurate or incomplete. In any case of the above.

Copyright permits this publication. Any other purposes permitted by the Copyright Act 1968, reproduction by any means (photocopying, electronic, mechanical, recording or otherwise) is prohibited without the prior written permission of the Department of Natural Resources, Mines & Energy.

All enquiries: The Maps, Topographic Data, Imagery & Mapping, Department of Natural Resources, Mines & Energy, GPO Box 2451, Brisbane, QLD 4001.

Produced by the Department of Natural Resources, Mines & Energy,
 © The State Of Queensland (Department of Natural Resources, Mines & Energy) January 2019.



1:23,000

0 0.1 0.2 0.3 0.4
Kilometres

Map Projection: GDA 1984

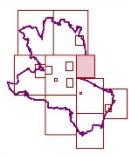

SHEET KEY

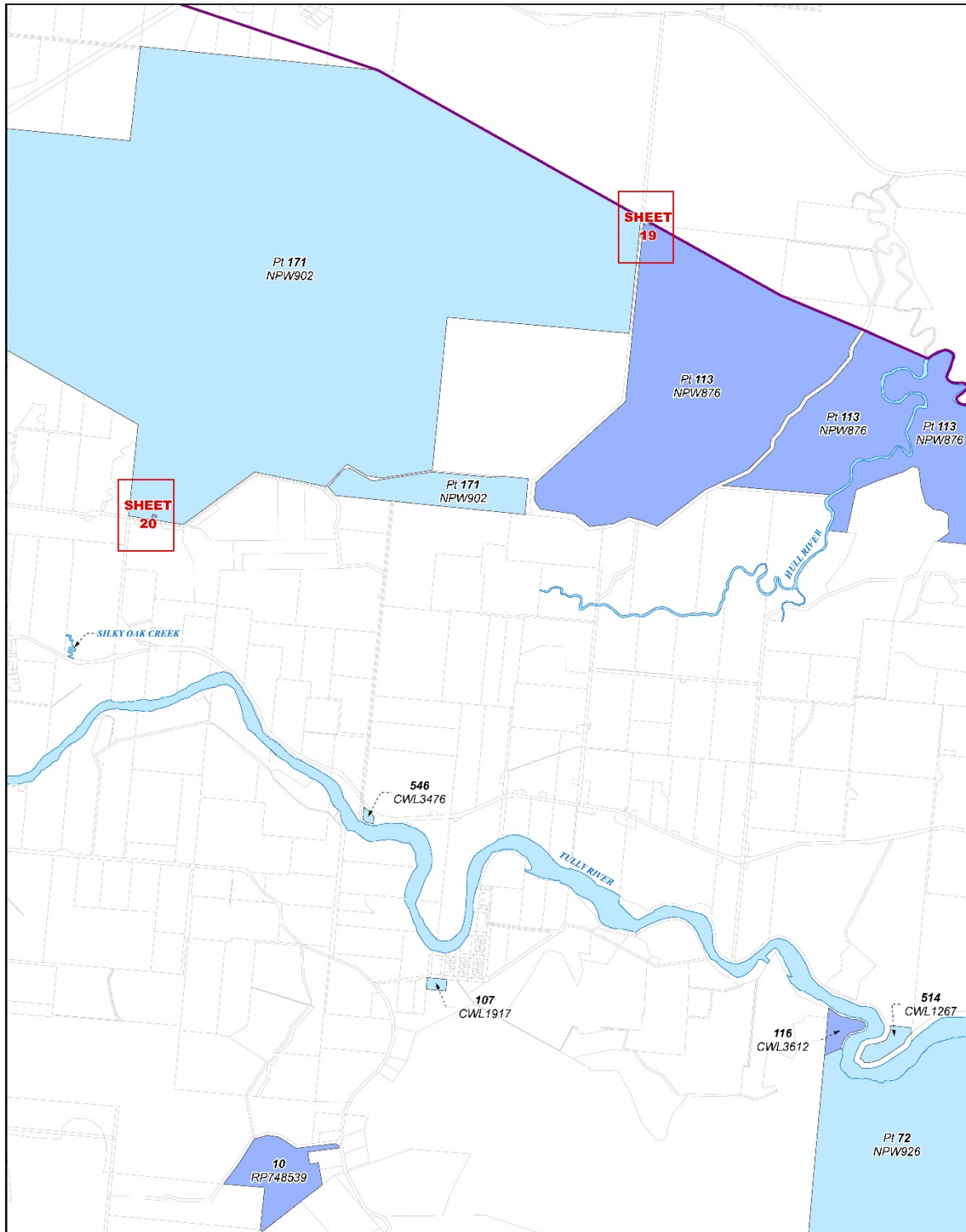

Document Path: K:\CLAIMMAP\2014\QCD2014_003_Gulngay_People\Determination_Map\MXD\QCD14_02_Gulngay_People_A3P_Determination_Mapbook_20181129.mxd

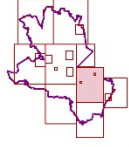
<p>LEGEND</p> <ul style="list-style-type: none"> Exclusive Native Title Non-exclusive Native Title External boundary DCDB 	<p>NATIVE TITLE DETERMINATION</p> <p>QUD308/2014 Gulngay People (QC2014/002) Sheet 18 of 26</p> <p><small>Copyright: Land Tenure Information obtained from the Digital Cadastre Data Base (June 2018), Department of Natural Resources, Mines & Energy, Brisbane. This (and any other) information is the property of the Department of Natural Resources, Mines & Energy and should be used for the purposes of the intended use only.</small></p> <p><small>Boundary lines shown on this map have been obtained from available information. It is possible that errors and omissions may exist. While every care is taken to ensure the accuracy of this data, the Department of Natural Resources, Mines & Energy, and/or its contractors do not accept any liability for any loss, damage, or expense, or for any consequences or actions of any kind, arising from the use of this data, or from any reliance on the accuracy, reliability, or completeness of this data, or from any use of this data for any purpose other than that for which it was intended. The Department of Natural Resources, Mines & Energy, and/or its contractors do not accept any liability for any loss, damage, or expense, or for any consequences or actions of any kind, arising from the use of this data, or from any reliance on the accuracy, reliability, or completeness of this data, or from any use of this data for any purpose other than that for which it was intended.</small></p> <p><small>Copyright remains the property of the Department of Natural Resources, Mines & Energy. All rights reserved. No part of this publication may be reproduced, stored in a retrieval system, or transmitted, in any form or by any means, electronic, mechanical, photocopying, recording, or otherwise, without the prior written permission of the Department of Natural Resources, Mines & Energy.</small></p> <p><small>All enquiries: The Maps and Topographic Data, Mapping, Department of Natural Resources, Mines & Energy, GPO Box 2451, Brisbane, QLD 4001.</small></p> <p><small>Produced by the Department of Natural Resources, Mines & Energy. © The State of Queensland (Department of Natural Resources, Mines & Energy) January 2019.</small></p>	 <p>1:35,000</p> <p>0 0.15 0.3 0.45 0.6 Kilometres</p> <p>Map Projection: GDA 1984</p>	 <p>SHEET KEY</p>
----------------------------------------------------------------------------------------------------------------------------------------------------------------------------------------------------------------------------------------------------------------------------------------------------------------------------------------------------------------------------------------------------------------------------------------------------------------------------------------------------------------------------------------------------------------------------------------------------------------------------------------------------------------	------------------------------------------------------------------------------------------------------------------------------------------------------------------------------------------------------------------------------------------------------------------------------------------------------------------------------------------------------------------------------------------------------------------------------------------------------------------------------------------------------------------------------------------------------------------------------------------------------------------------------------------------------------------------------------------------------------------------------------------------------------------------------------------------------------------------------------------------------------------------------------------------------------------------------------------------------------------------------------------------------------------------------------------------------------------------------------------------------------------------------------------------------------------------------------------------------------------------------------------------------------------------------------------------------------------------------------------------------------------------------------------------------------------------------------------------------------------------------------------------------------------------------------------------------------------------------------------------------------------------------------------------------------------------------------------------------------------------------------------------------------------------------------------------------------------------------------------------------------------------------------------------------------------------------------------------------------------------------------------------------------------------------------------------------------------------------------------------------------------------------------------------------------------------------------------------------------------------------------------------------------------------------------------------------------------------------------------	----------------------------------------------------------------------------------------------------------------------------------------------------------------------------------------	---------------------------------------------------------------------------------------------------------------

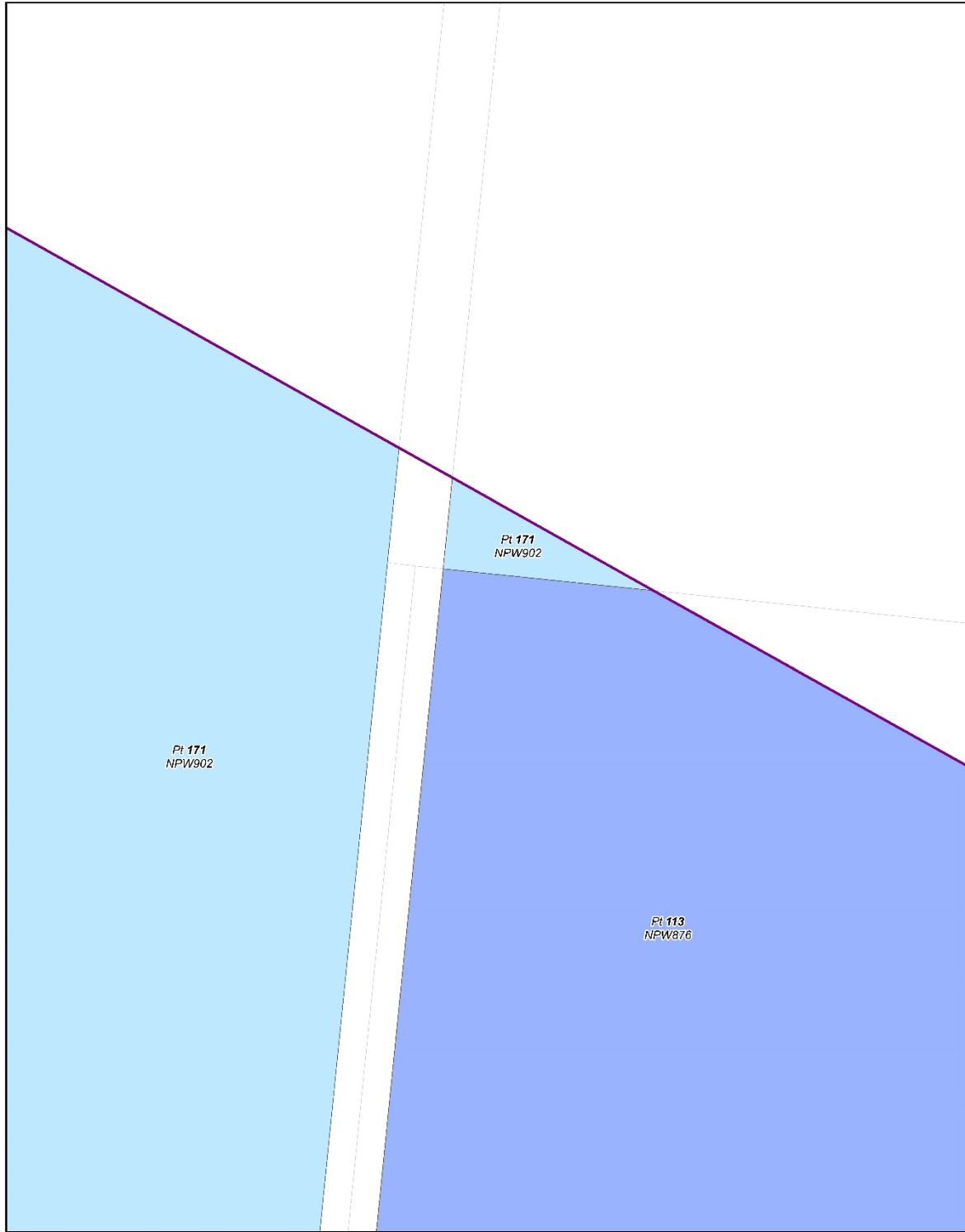

Document Path: K:\CLAIMMAP\2014\QCD2014_003_Gulgay_People\Determination_Map\MXD\QCD14_02_Gulgay_People_A3P_Determination_Mapbook_20181129.mxd

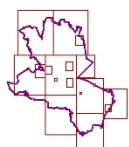
<p>LEGEND</p> <ul style="list-style-type: none"> Exclusive Native Title Non-exclusive Native Title External boundary DCDB 	<p>NATIVE TITLE DETERMINATION</p> <p>QUD308/2014 Gulgay People (QC2014/002) Sheet 19 of 26</p> <p><small>Copyright: Land Tenure Information obtained from the Digital Cadastre Data Base (June 2018), Department of Natural Resources, Mines & Energy, Brisbane. The Department of Natural Resources, Mines & Energy should be consulted for verification of tenures.</small></p> <p><small>Frontier names shown on this map have been obtained from available information. It is possible that errors and omissions may exist. While every care is taken to ensure the accuracy of this data, the Department of Natural Resources, Mines & Energy, and its contractors, make no representation or warranty as to the accuracy, reliability, completeness or suitability of any data for any purpose and do not accept any responsibility for any liability (including without limitation, liability in negligence) for any damages (including indirect or consequential) or costs which might be incurred in reliance on the data being inaccurate or incomplete, in any way or for any reason.</small></p> <p><small>Copyright remains the sole property of the Queensland Government. All other rights reserved. Reproduction by any means (photocopying, electronic, mechanical, recording or otherwise) is prohibited without the prior written permission of the Department of Natural Resources, Mines & Energy.</small></p> <p><small>All enquiries: The Mapping, Topographic Data, Imagery & Mapping, Department of Natural Resources, Mines & Energy, GPO Box 2451, Brisbane, QLD 4001</small></p> <p><small>Produced by the Department of Natural Resources, Mines & Energy. © The State Of Queensland (Department of Natural Resources, Mines & Energy) January 2019.</small></p>	 <p>1:2,000</p> <p><small>0 0.01 0.02 0.03 0.04 Kilometres</small></p> <p><small>Map Projection: GDA 1984</small></p>	 <p>SHEET KEY</p>
------------------------------------------------------------------------------------------------------------------------------------------------------------------------------------------------------------------------------------------------------------------------------------------------------------------------------------------------------------------------------------------------------------------------------------------------------------------------------------------------------------------------------------------------------------------------------------------------------------------------------------------------------------------------------------------------------------------	--------------------------------------------------------------------------------------------------------------------------------------------------------------------------------------------------------------------------------------------------------------------------------------------------------------------------------------------------------------------------------------------------------------------------------------------------------------------------------------------------------------------------------------------------------------------------------------------------------------------------------------------------------------------------------------------------------------------------------------------------------------------------------------------------------------------------------------------------------------------------------------------------------------------------------------------------------------------------------------------------------------------------------------------------------------------------------------------------------------------------------------------------------------------------------------------------------------------------------------------------------------------------------------------------------------------------------------------------------------------------------------------------------------------------------------------------------------------------------------------------------------------------------------------------------------------------------------------------------------------------------------------------------------------------------------------------------------------------------------------------------------------------------------------------------------------------------------------------------------	-----------------------------------------------------------------------------------------------------------------------------------------------------------------------------------------------------------------------	---------------------------------------------------------------------------------------------------------------

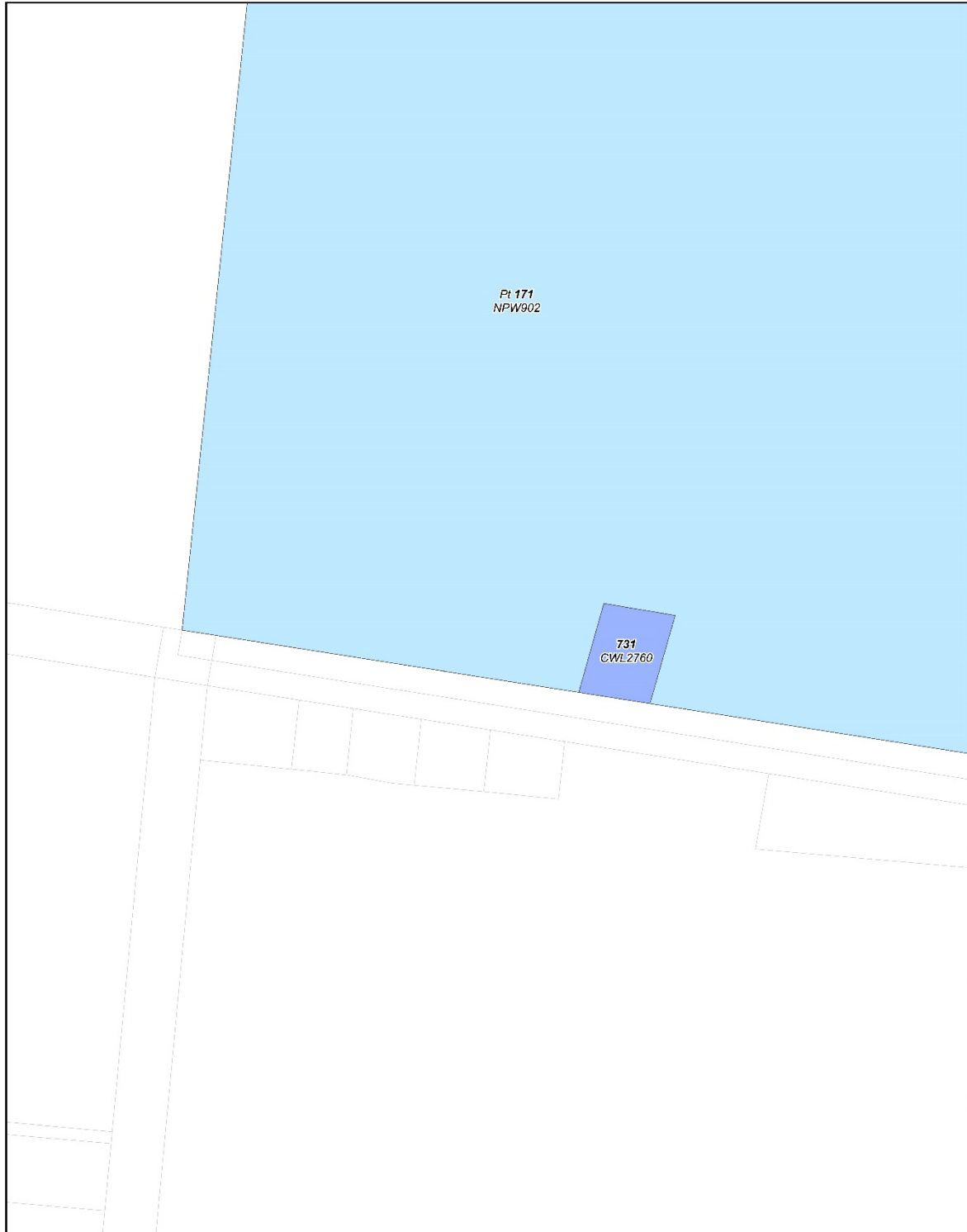

Document Path: K:\CLAIMMAP\2014\QCD2014_003_Gulgungay_People\Determination_Map\MXD\QCD14_02_Gulgungay_People_A3P_Determination_Mapbook_20181129.mxd

NATIVE TITLE DETERMINATION

QUD308/2014 Gulgungay People (QC2014/002) Sheet 20 of 26

Copyright: Land Tenure Information obtained from the Digital Cadastre Data Base (June 2018), Department of Natural Resources, Mines & Energy, Brisbane. The Land Registry is the Department of Natural Resources, Mines & Energy should be consulted for verification of tenures.

From the names shown on this map have been obtained from available information, it is possible that errors and omissions may exist. While every care is taken to ensure the accuracy of this data, the Department of Natural Resources, Mines & Energy, and its contractors, make no representation or warranty as to the accuracy, reliability, completeness or suitability of any data for any purpose and of so far as a responsibility for any liability (including without limitation, liability in negligence) for any losses, expenses, costs, damages (including indirect or consequential) and costs which might be incurred in connection with the data being inaccurate or incomplete, is hereby excluded.

Copyright permits in this work, in so far as the purposes permitted by the Copyright Act 1969, reproduction by any means (photographic, electronic, mechanical, recording or otherwise) is prohibited without the prior written permission of the Department of Natural Resources, Mines & Energy. All enquiries: The Maps and Topographic Data, Mapping, Department of Natural Resources, Mines & Energy, GPO Box 2451, Brisbane, QLD 4001.

Produced by the Department of Natural Resources, Mines & Energy,
 © The State Of Queensland (Department of Natural Resources, Mines & Energy) January 2019.

LEGEND

- Exclusive Native Title
- Non-exclusive Native Title
- External boundary
- DCDB

1:2,000

0 0.01 0.02 0.03 0.04
Kilometres

SHEET KEY

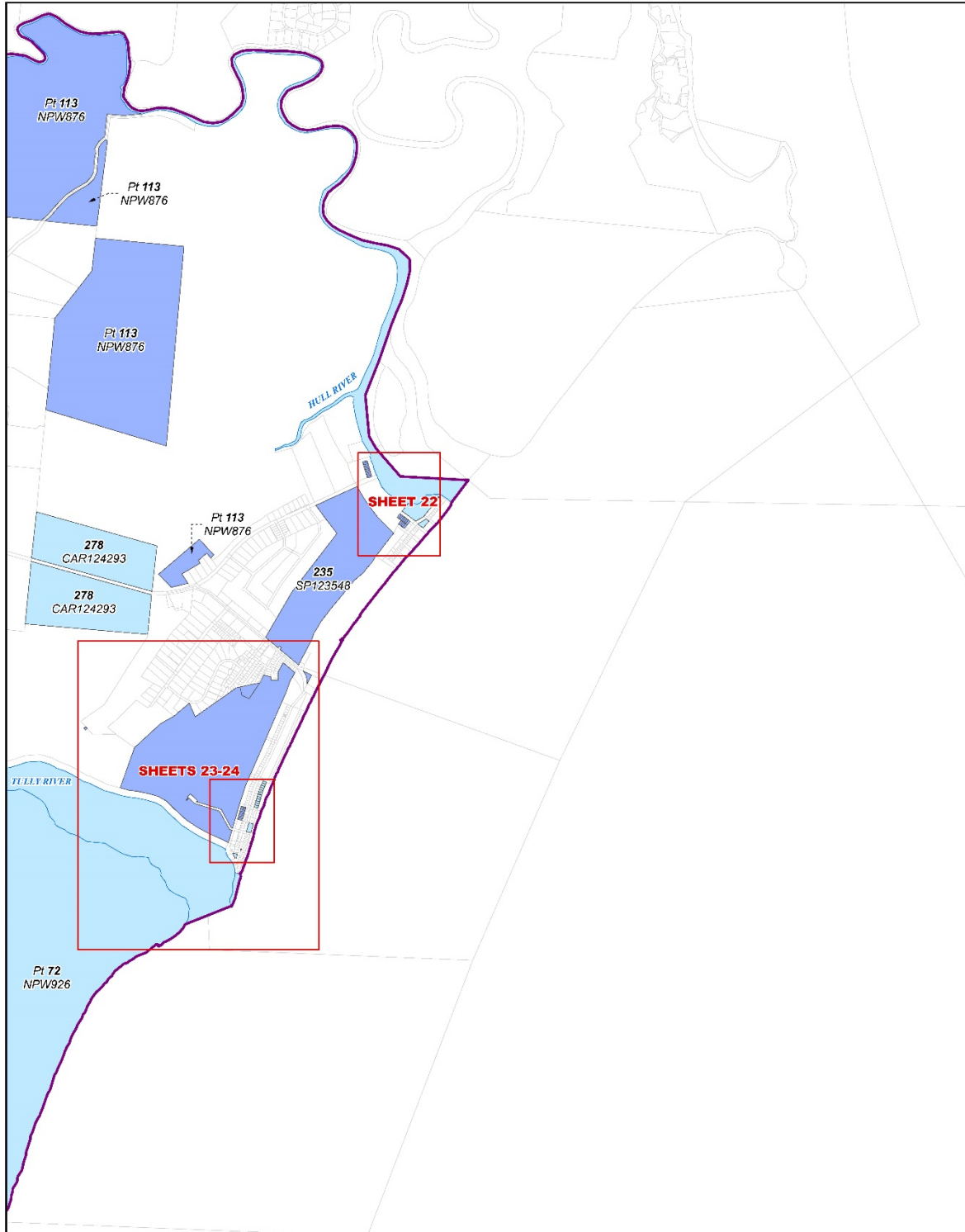

Document Path: K:\CL\MMAP\2014\QCD2014_002_Gulguy_People\Map\QCD14_02_Gulguy_People_ASP_Determination_Mapbook_20181129.mxd

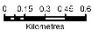
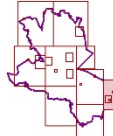
<p>LEGEND</p> <ul style="list-style-type: none"> Exclusive Native Title Non-exclusive Native Title External boundary DCDA 	<p>NATIVE TITLE DETERMINATION</p> <p>QUD308/2014 Gulguy People (QC2014/002) Sheet 21 of 26</p> <p><small>Copyright: Land Tenure Information obtained from the Digital Cadastral Data Base (Dunlop) of Natural Resources, Mines & Energy, Brisbane. For use only by the Department of Natural Resources, Mines & Energy should be reserved for use only on all maps.</small></p> <p><small>Errors: Errors shown on this map have been identified from available information. It is possible that errors and omissions may exist. While every effort is made to ensure the accuracy of this data, the Department of Natural Resources, Mines & Energy and/or contributors to this map do not represent or warrant as to the accuracy, reliability, completeness or suitability of any data for any purpose and do not accept any liability (including negligence, whether in contract, tort or otherwise) for any damages, losses, expenses, costs, or other consequences or otherwise, in a contractual or otherwise, arising out of or from the use of this data for any purpose, in any way or for any reason.</small></p> <p><small>Copyright protects this map. Reproduction for purposes permitted by the Copyright Act 1968, reproduction by any means (photocopying, electronic, mechanical, recording or otherwise) is prohibited without the prior written permission of the Department of Natural Resources, Mines & Energy.</small></p> <p><small>All enquiries: The Mapping, Topographic Data, Mapping, Department of Natural Resources, Mines & Energy, GPO Box 2450, Brisbane, QLD 4001</small></p> <p><small>Produced by the Department of Natural Resources, Mines & Energy</small></p> <p><small>© The State Of Queensland (Department of Natural Resources, Mines & Energy) January 2019.</small></p>	 <p>1:30,000</p>  <p>Map Projection: GDA 2014 1984</p>
		 <p>SHEET KEY</p>

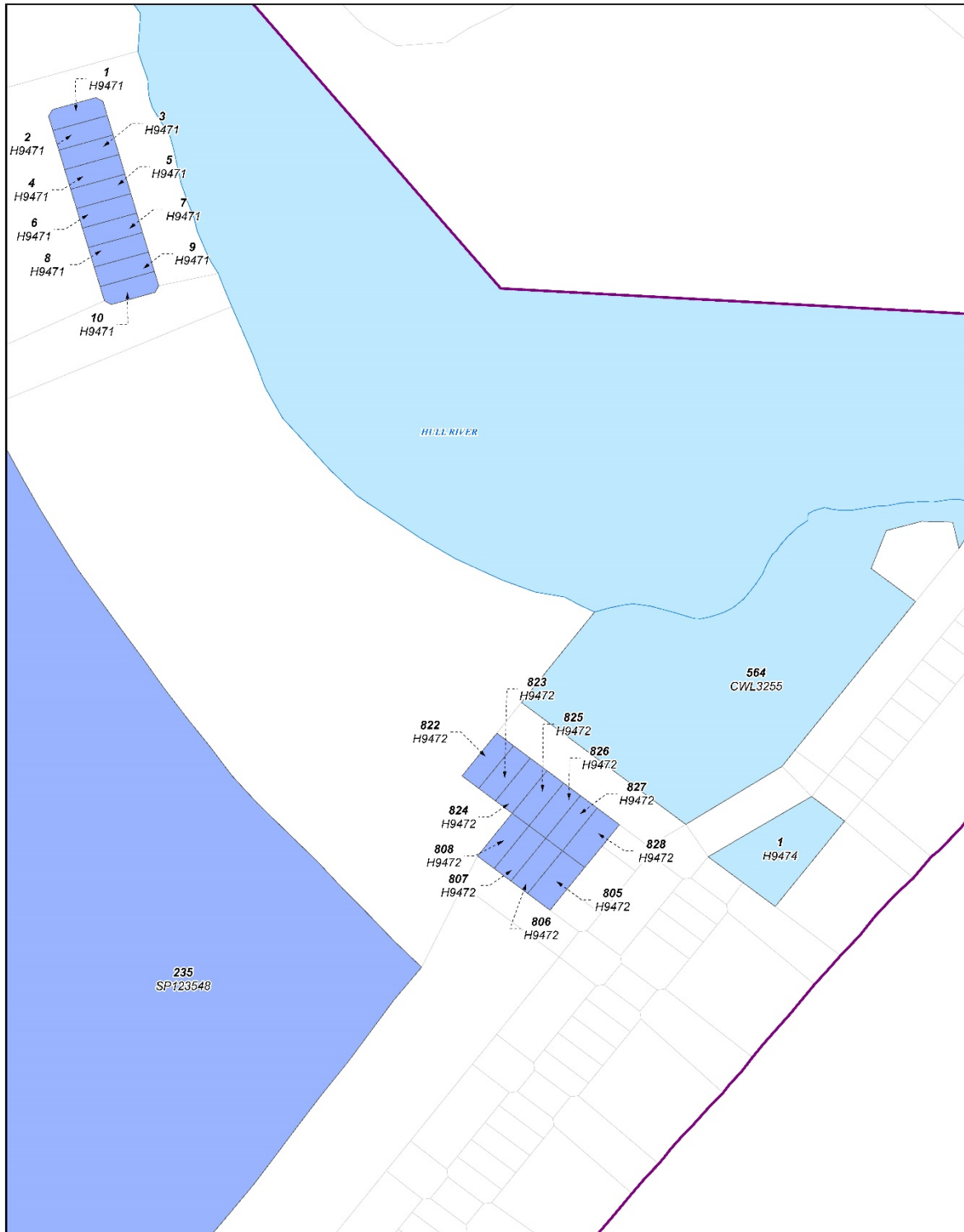

Document Path: K:\CLAIMMAP\2014\QCD2014_003_Gulgay_People\Determination_Map\MXD\QCD14_02_Gulgay_People_ASP_Determination_Mapbook_20181129.mxd

LEGEND

- Exclusive Native Title
- Non-exclusive Native Title
- External boundary
- DCDB

NATIVE TITLE DETERMINATION

QUD308/2014 Gulgay People (QC2014/002) Sheet 22 of 26

Copyright: Land Tenure Information obtained from the Digital Cadastre Data Base (June 2018), Department of Natural Resources, Mines & Energy, Brisbane. The (and any) in the Department of Natural Resources, Mines & Energy should be consulted for verification of tenures.

Front: names shown on this map have been obtained from available information. It is possible that errors and omissions may exist. While every care is taken to ensure the accuracy of this data, the Department of Natural Resources, Mines & Energy, and/or its contractors do not accept any liability for any inaccuracies, errors, omissions or damages (including indirect or consequential) or costs which might be incurred in reliance on the data being inaccurate or incomplete. In no way or for any reason.

Copyright remains the sole property of the Queensland Government. All other rights reserved. Reproduction by any means (photocopying, electronic, mechanical, recording or otherwise) is prohibited without the prior written permission of the Department of Natural Resources, Mines & Energy.

All enquiries: The Mapping, Topographic Data, Mapping, Department of Natural Resources, Mines & Energy, GPO Box 2451, Brisbane, QLD 4001.

Produced by the Department of Natural Resources, Mines & Energy,
 © The State Of Queensland (Department of Natural Resources, Mines & Energy) January 2019.



1:2,500
Kilometres

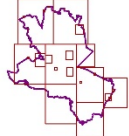

SHEET KEY

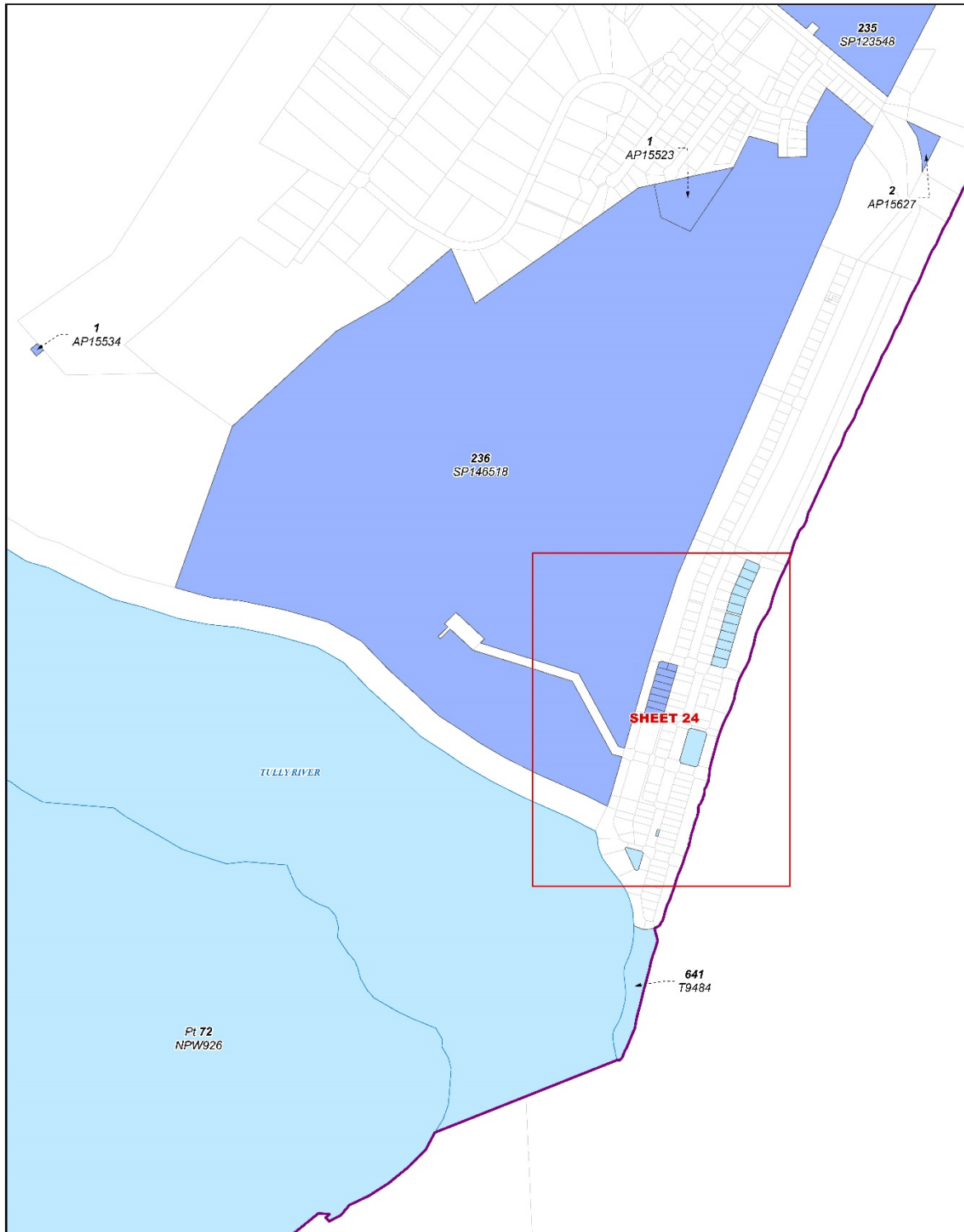

Document Path: K:\CLAIMMAP\2014\QCD2014_002_Gulgungy_People\Determinaion_Map\MXD\QCD14_02_Gulgungy_People_A3P_Determinaion_Mapbook_20181129.mxd

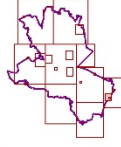
<p>LEGEND</p> <ul style="list-style-type: none"> Exclusive Native Title Non-exclusive Native Title External boundary DCDB 	<p>NATIVE TITLE DETERMINATION</p> <p>QUD308/2014 Gulgungy People (QC2014/002) Sheet 23 of 26</p> <p><small>Copyright: Land Tenure Information obtained from the Digital Cadastre Data Base (June 2018), Department of Natural Resources, Mines & Energy, Brisbane. This (and any other) is the domain of Natural Resources, Mines & Energy should be consulted for verification of tenures.</small></p> <p><small>Frontier names shown on this map have been obtained from available information. It is possible that errors and omissions may exist. While every care is taken to ensure the accuracy of this data, the Department of Natural Resources, Mines & Energy, and/or its contractors do not accept any responsibility for any errors, omissions, inaccuracies, or damages (including indirect or consequential) or costs which might be incurred in reliance on the data being inaccurate or incomplete. In no way or for any reason.</small></p> <p><small>Copyright permits this map to be used for purposes permitted by the Copyright Act 1968, reproduction by any means (photocopying, electronic, mechanical, recording or otherwise) is prohibited without the prior written permission of the Department of Natural Resources, Mines & Energy.</small></p> <p><small>All enquiries: The Maps and Topographic Data Mapping, Department of Natural Resources, Mines & Energy, GPO Box 2451, Brisbane, QLD 4001.</small></p> <p><small>Produced by the Department of Natural Resources, Mines & Energy. © The State Of Queensland (Department of Natural Resources, Mines & Energy) January 2019.</small></p>	 <p>1:7,500</p> <p><small>0 0.0856 076 1650.14 Metres</small></p> <p><small>Map Projection: GDA 1984</small></p>	 <p>SHEET KEY</p>
-------------------------------------------------------------------------------------------------------------------------------------------------------------------------------------------------------------------------------------------------------------------------------------------------------------------------------------------------------------------------------------------------------------------------------------------------------------------------------------------------------------------------------------------------------------------------------------------------------------------------------------------------------------------------------------------------------------------	--------------------------------------------------------------------------------------------------------------------------------------------------------------------------------------------------------------------------------------------------------------------------------------------------------------------------------------------------------------------------------------------------------------------------------------------------------------------------------------------------------------------------------------------------------------------------------------------------------------------------------------------------------------------------------------------------------------------------------------------------------------------------------------------------------------------------------------------------------------------------------------------------------------------------------------------------------------------------------------------------------------------------------------------------------------------------------------------------------------------------------------------------------------------------------------------------------------------------------------------------------------------------------------------------------------------------------------------------------------------------------------------------------------------------------------------------------------------------------------------------------------------------------------------------------------------------------------------------------------------------------------------------------------------------------------------	-------------------------------------------------------------------------------------------------------------------------------------------------------------------------------------------------------------------------------	---------------------------------------------------------------------------------------------------------------

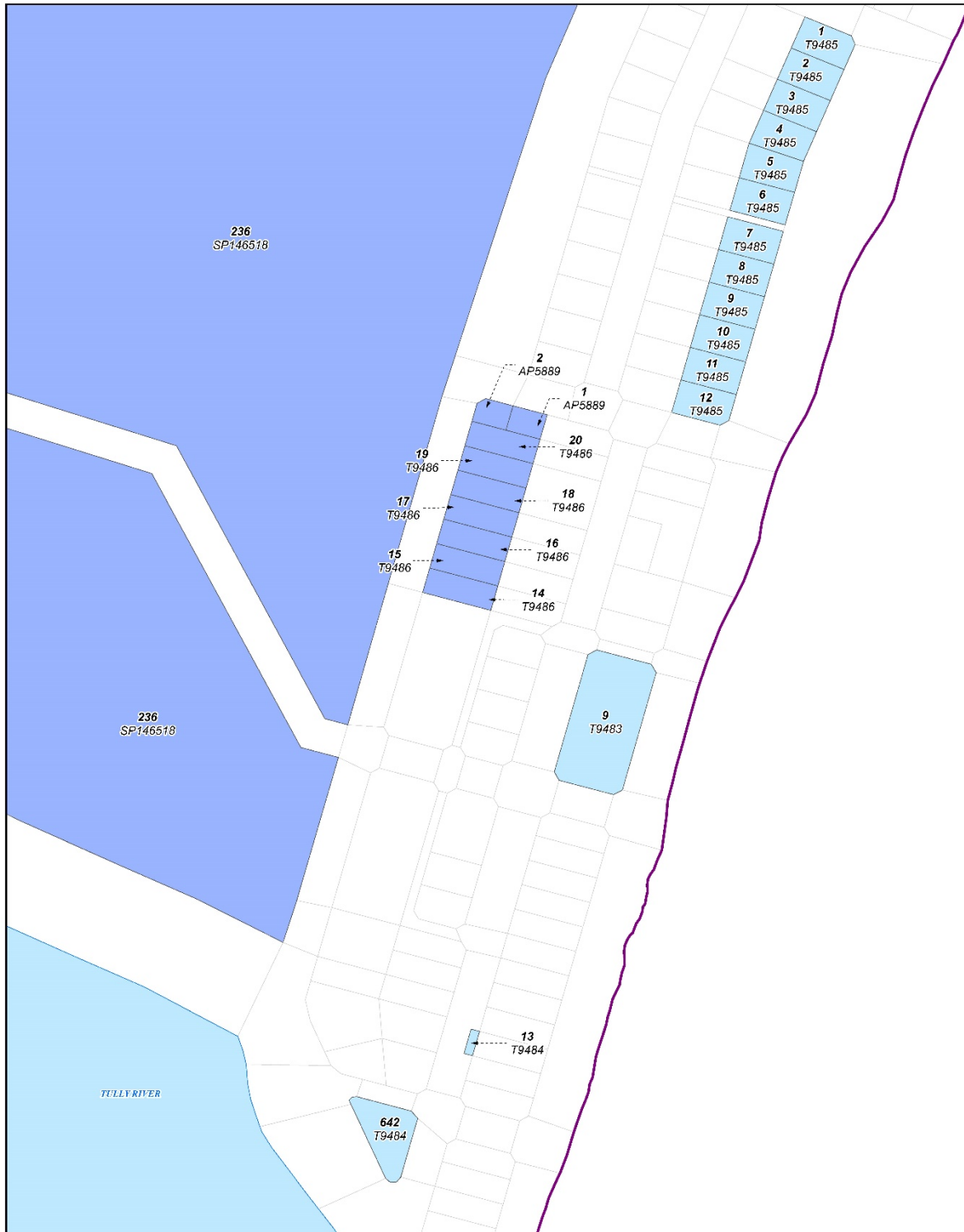

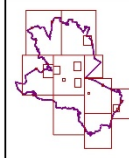

Document Path: K:\CLAIMMAP\2014\QCD2014_002 Gulngay People\Determination_Map\MXD\QCD14_02_Gulngay_People_A3P_Determination_Mapbook_20181129.mxd

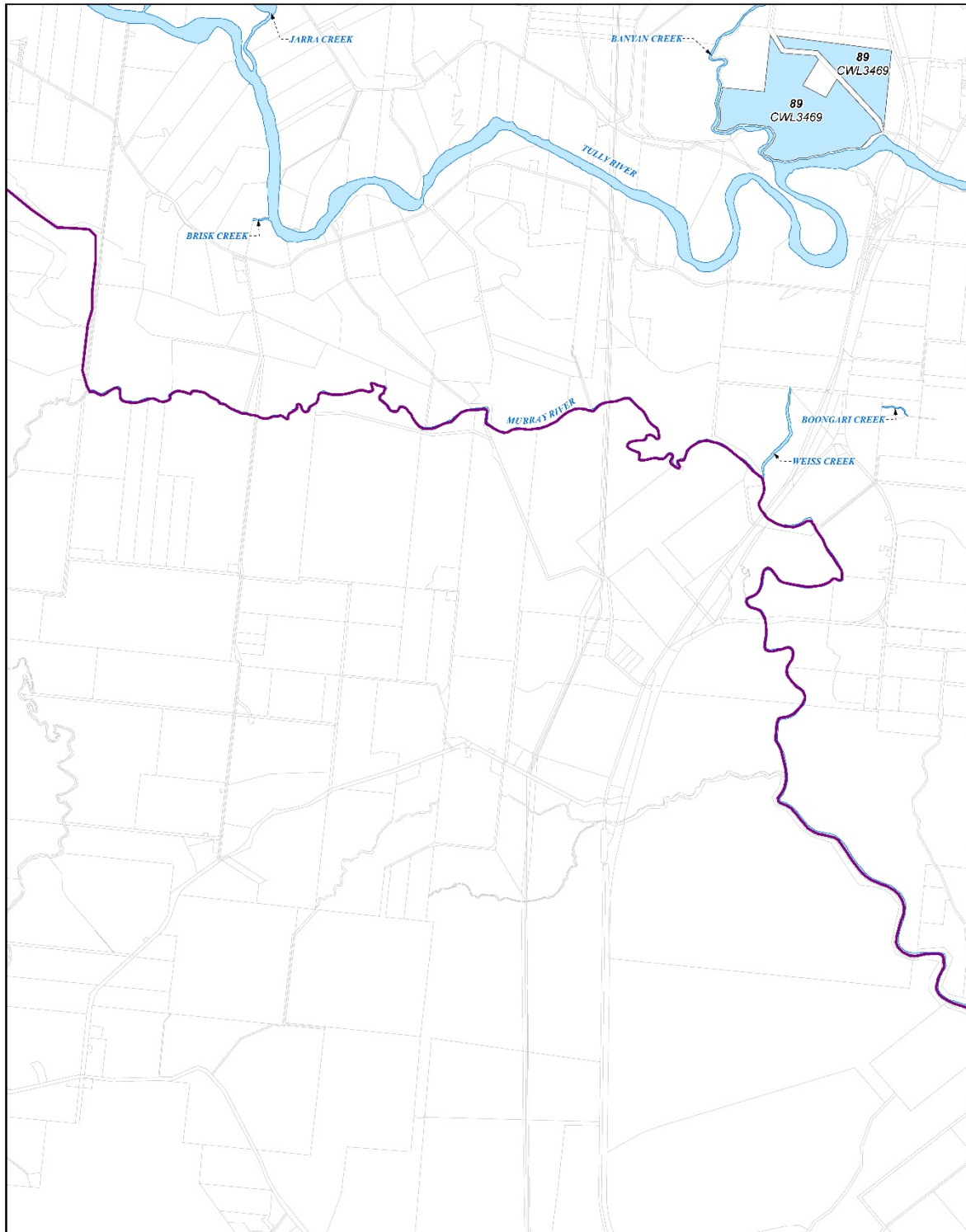
<p>LEGEND</p> <ul style="list-style-type: none"> Exclusive Native Title Non-exclusive Native Title External boundary DCDB 	<p>NATIVE TITLE DETERMINATION</p> <p>QUD308/2014 Gulngay People (QC2014/002) Sheet 24 of 26</p> <p><small>Copyright: Land Tenure Information obtained from the Digital Cadastre Data Base (June 2018), Department of Natural Resources, Mines & Energy, Brisbane. The (and any) in the Department of Natural Resources, Mines & Energy should be consulted for verification of tenures.</small></p> <p><small>From the names shown on this map have been obtained from available information. It is possible that errors and omissions may exist. While every care is taken to ensure the accuracy of this data, the Department of Natural Resources, Mines & Energy, and/or its contractors do not accept any liability for any loss or damage, including consequential, arising from the use of this data for any purpose and/or for any reason. Liability is limited to the extent of the contract. The Department of Natural Resources, Mines & Energy, and/or its contractors do not accept any liability for any loss or damage, including consequential, arising from the use of this data for any purpose and/or for any reason.</small></p> <p><small>Copyright remains the property of the State of Queensland. All rights reserved. No part of this publication may be reproduced, stored in a retrieval system, or transmitted, in any form or by any means, electronic, mechanical, recording or otherwise, without the prior written permission of the Department of Natural Resources, Mines & Energy.</small></p> <p><small>All enquiries: The Maps, Topographic Data, Imagery & Mapping, Department of Natural Resources, Mines & Energy, GPO Box 2451, Brisbane, QLD 4001.</small></p> <p><small>Produced by the Department of Natural Resources, Mines & Energy.</small></p> <p><small>© The State Of Queensland (Department of Natural Resources, Mines & Energy) January 2019.</small></p>	 <p>1:2,000</p> <p><small>0 0.01 0.02 0.03 0.04</small> Kilometres</p> <p><small>Map Projection: GDA 1984</small></p>
		 <p>SHEET KEY</p>

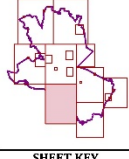

Document Path: K:\CLAIMMAP\2014\QCD2014_002 Gulngay People\Determinaion_Map\MXD\QCD2014_02_Gulngay People_ASP_Determination_Mapbook_20181129.mxd

NATIVE TITLE DETERMINATION		
QUD308/2014 Gulngay People (QC2014/002) Sheet 25 of 26		
<p><small>Completion: Land Tenure Information obtained from the Digital Cadastre Data Base (June 2018), Department of Natural Resources, Mines & Energy, Brisbane. This (and any) is the Department of Natural Resources, Mines & Energy should be consulted for verification of tenures.</small></p> <p><small>From: names shown on this map have been obtained from available information. It is possible that errors and omissions may exist. While every care is taken to ensure the accuracy of this data, the Department of Natural Resources, Mines & Energy, and its contractors, do not accept any responsibility for any errors, omissions, or inaccuracies in this data. The user of this data is advised to verify the accuracy, reliability, completeness or suitability of any data for any purpose and to take all reasonable precautions to protect themselves from any loss or damage which may arise from its use. The user of this data is advised to verify the accuracy, reliability, completeness or suitability of any data for any purpose and to take all reasonable precautions to protect themselves from any loss or damage which may arise from its use.</small></p> <p><small>Copyright permits to this (and) any of the purposes permitted by the Copyright Act 1968, reproduction by any means (photographic, electronic, mechanical, recording or otherwise) is prohibited without the prior written permission of the Department of Natural Resources, Mines & Energy. All enquiries: The Mapping, Topographic Data, Mapping, Department of Natural Resources, Mines & Energy, GPO Box 2451, Brisbane, QLD 4001.</small></p> <p style="text-align: center;"><small>Produced by the Department of Natural Resources, Mines & Energy, © The State Of Queensland (Department of Natural Resources, Mines & Energy) January 2019.</small></p>		
<p>LEGEND</p> <ul style="list-style-type: none"> Exclusive Native Title Non-exclusive Native Title External boundary DCDB 	 <p>1:40,000</p>  <p>Map Projection: GDA 1984</p>	 <p>SHEET KEY</p>

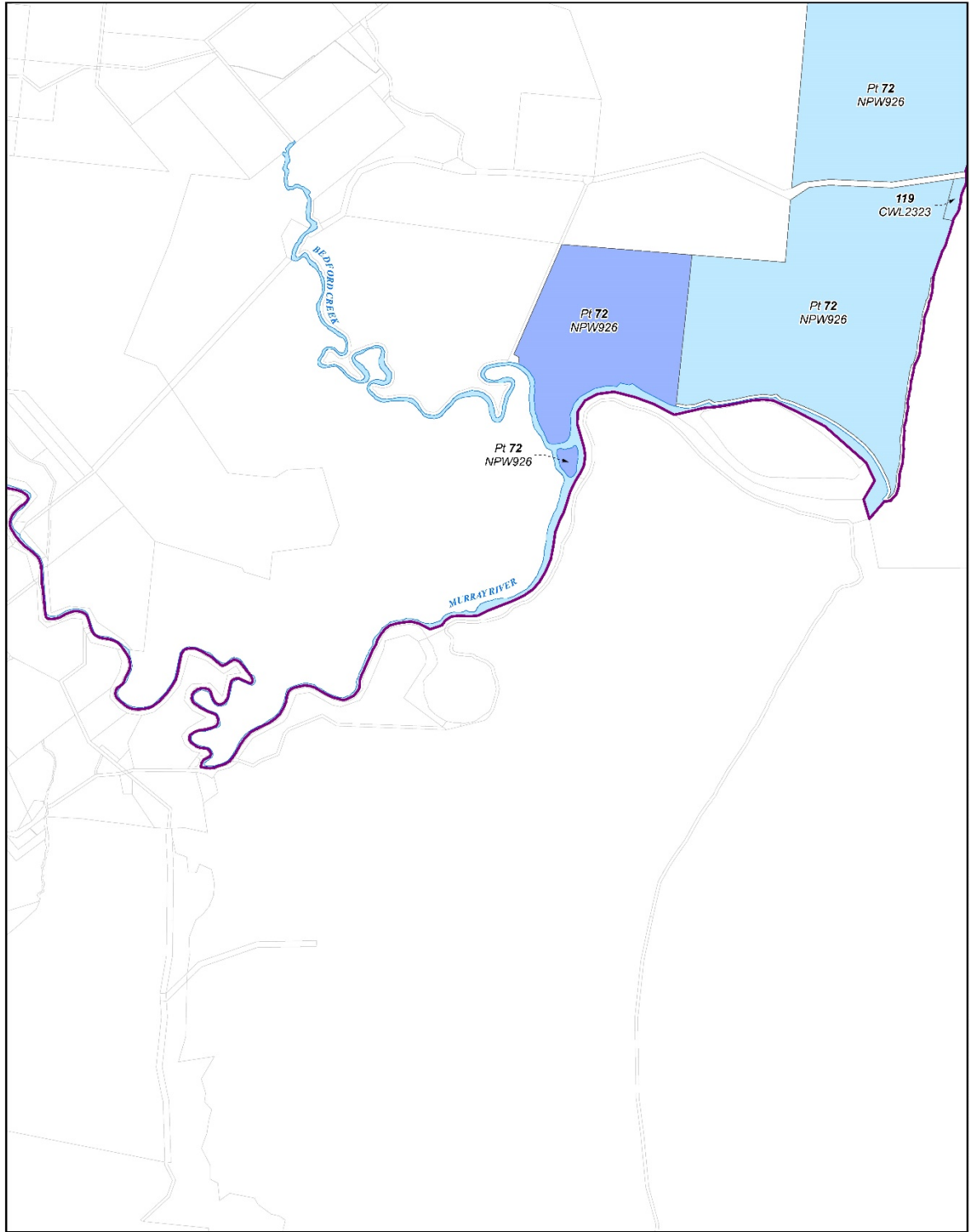

Document Path: K:\CLAIMMAP\2014\QCD2014_003 Gulngay People\Determination_Map\MXD\QCD14_02_Gulngay_People_A3P_Determination_Mapbook_20181129.mxd

NATIVE TITLE DETERMINATION

QUD308/2014 Gulngay People (QC2014/002) Sheet 26 of 26

LEGEND

- Exclusive Native Title
- Non-exclusive Native Title
- External boundary
- DCDB

Caution: Land Tenure Information obtained from the Digital Cadastre Data Base (June 2018), Department of Natural Resources, Mines & Energy, Brisbane. This (and any other) is the best current information available and should be used for reference only. It is possible that errors and omissions may exist. While every care is taken to ensure the accuracy of this data, the Department of Natural Resources, Mines & Energy, and/or its contractors do not accept any responsibility for any errors, omissions, inaccuracies, or damages (including indirect or consequential) arising from its use. For more information, please contact the Department of Natural Resources, Mines & Energy.

Copyright permits this map to be reproduced for non-commercial purposes only. Any reproduction, in any form or by any means (electronic, mechanical, photocopying, recording or otherwise), is prohibited without the prior written permission of the Department of Natural Resources, Mines & Energy.

All enquiries: The Maps and Topographic Data Mapping, Department of Natural Resources, Mines & Energy, GPO Box 2451, Brisbane, QLD 4001.

Produced by the Department of Natural Resources, Mines & Energy.
 © The State Of Queensland (Department of Natural Resources, Mines & Energy) January 2019.



1:35,000

0 0.15 0.3 0.45 0.6 Kilometres

Map Projection: GDA 1984

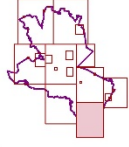

SHEET KEY